

TOP THUMB!



BUILD GUIDE



60x
2780
Black



2x
60484
Black

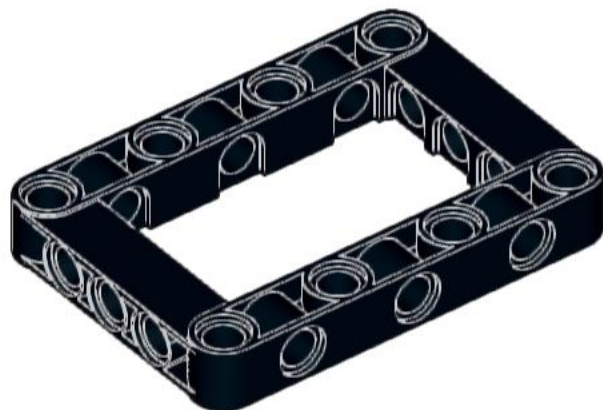

1x
64179
Black

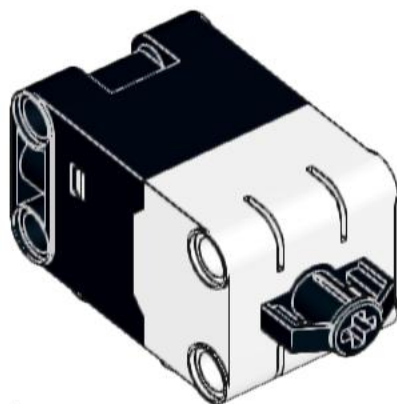

1x
37312c01
Black

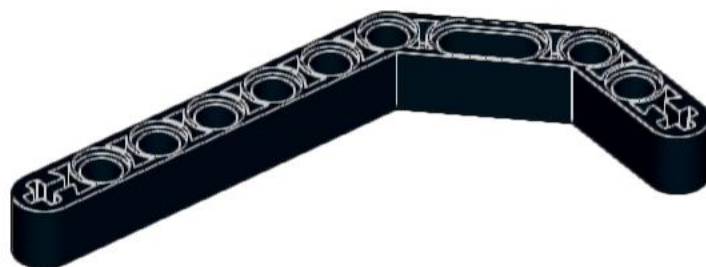

1x
32009
Black



1x
32278
Black

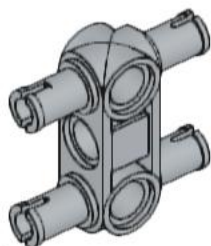

6x
48989
Light Bluish Gray

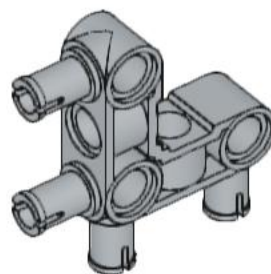

1x
55615
Light Bluish Gray



1x
14769pb209
White

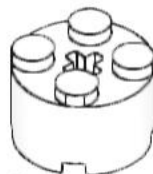

1x
3941
White

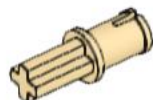

3x
3749
Tan

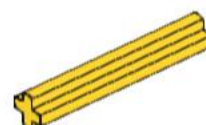

1x
4519
Yellow

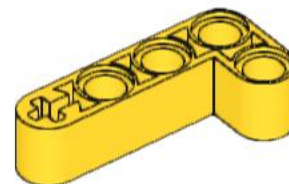

2x
32140
Yellow

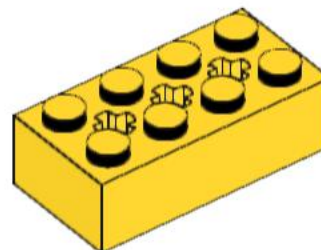

1x
39789
Yellow

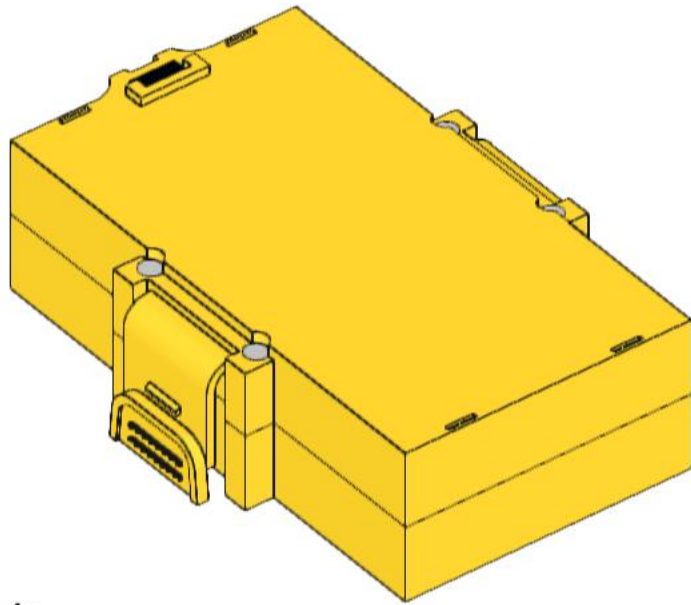

1x
55422c01
Yellow

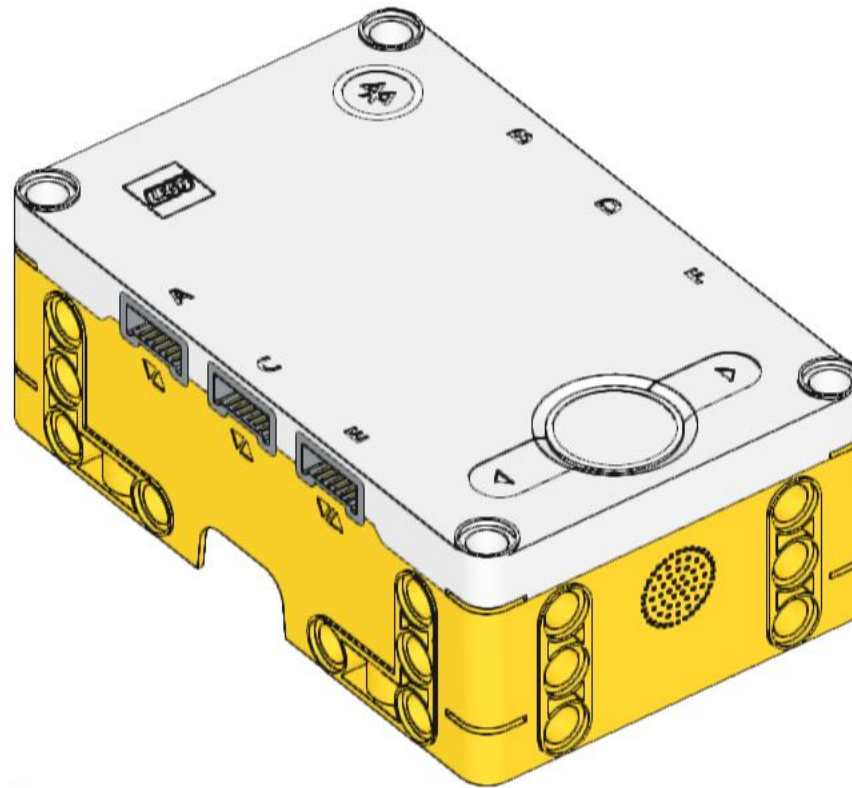

1x
bb1142c01
Yellow

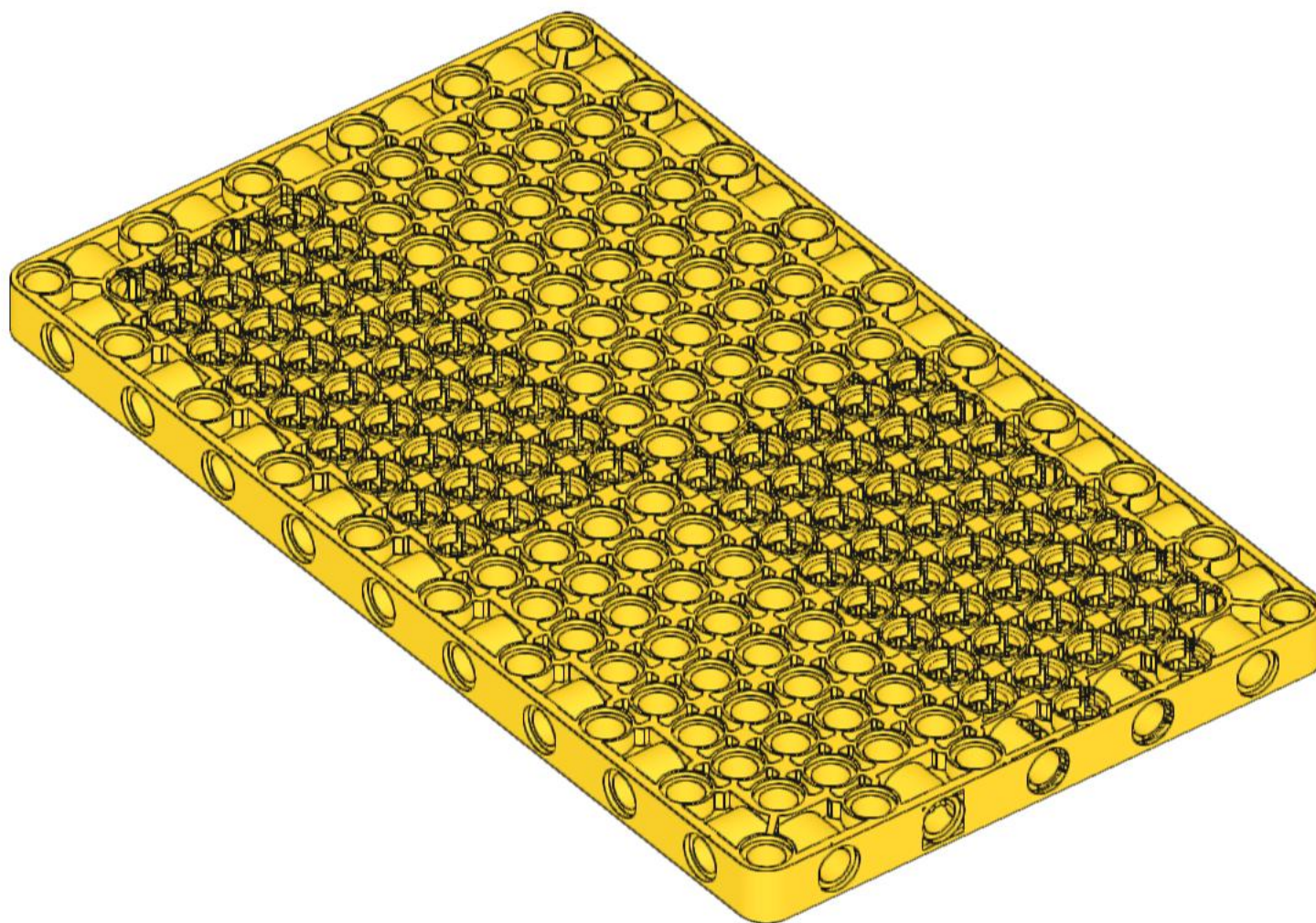

2x
39369
Yellow

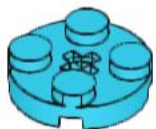

1x
4032
Medium Azure

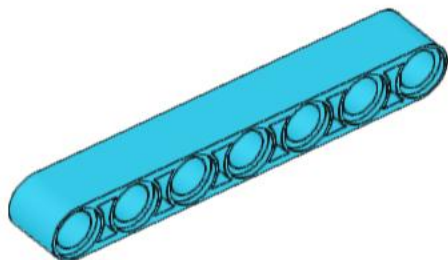

1x
32524
Medium Azure

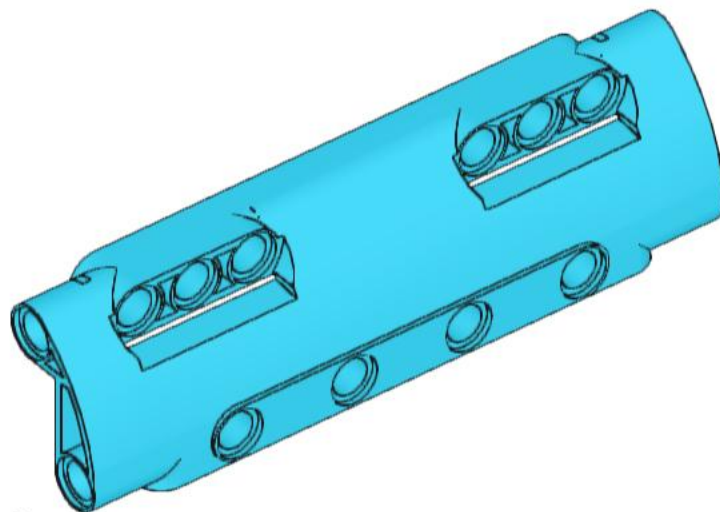

2x
11954
Medium Azure

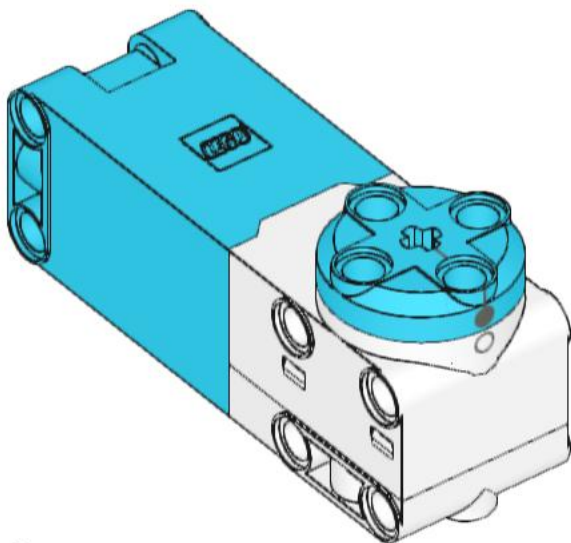

2x
54696c01
Medium Azure

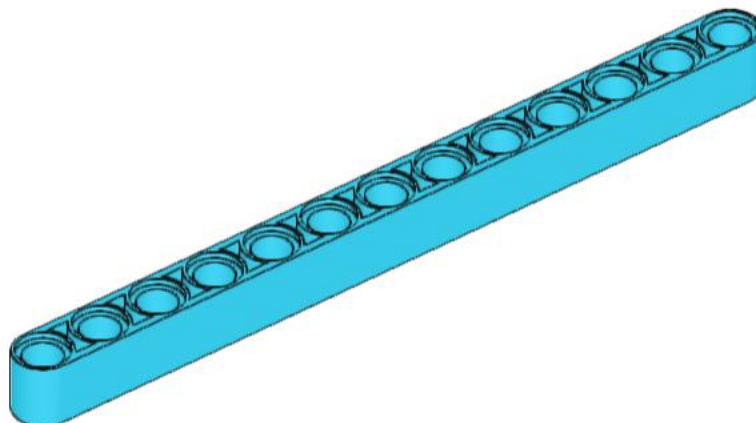

2x
41239
Medium Azure

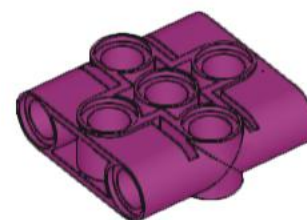
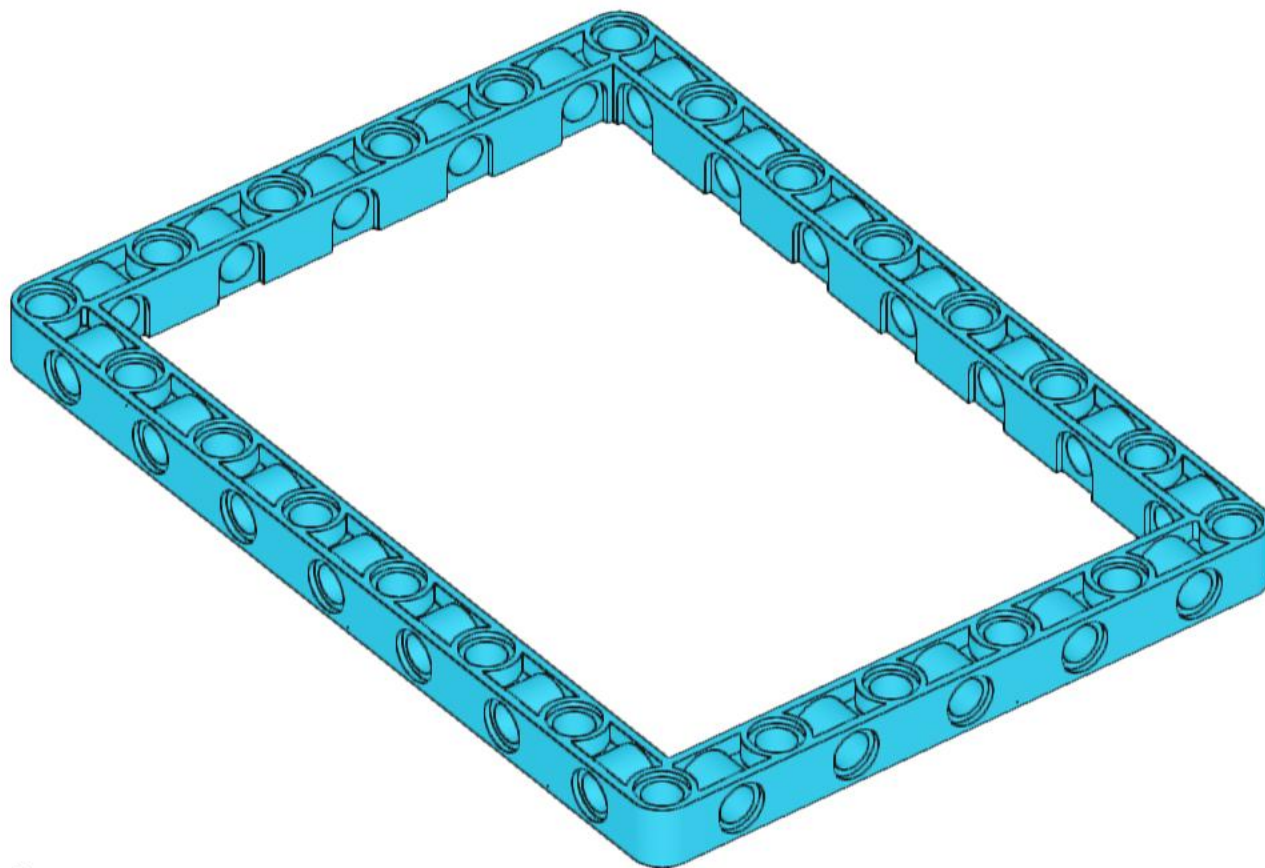

2x
39793
Magenta

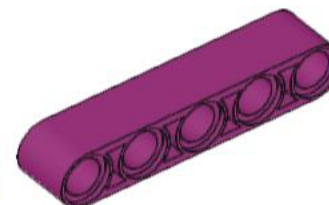

3x
32316
Magenta

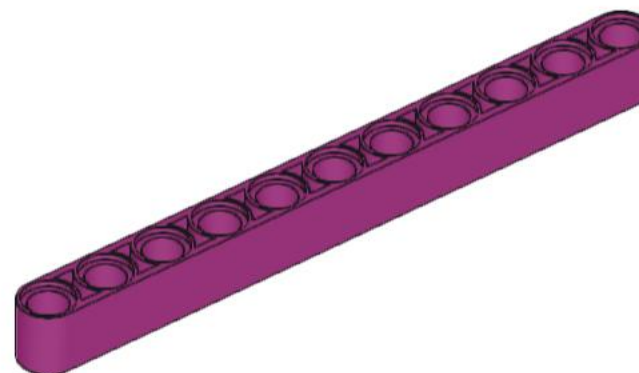

6x
32525
Magenta

2x
39790
Medium Azure



3x
6558
Blue

1

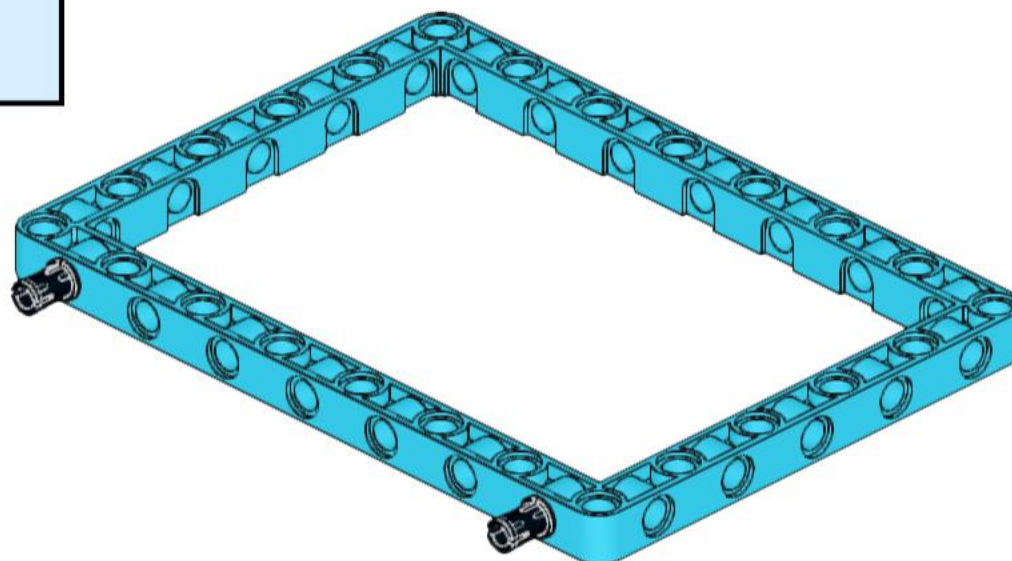
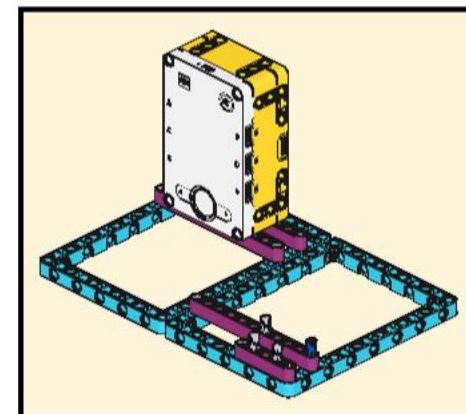
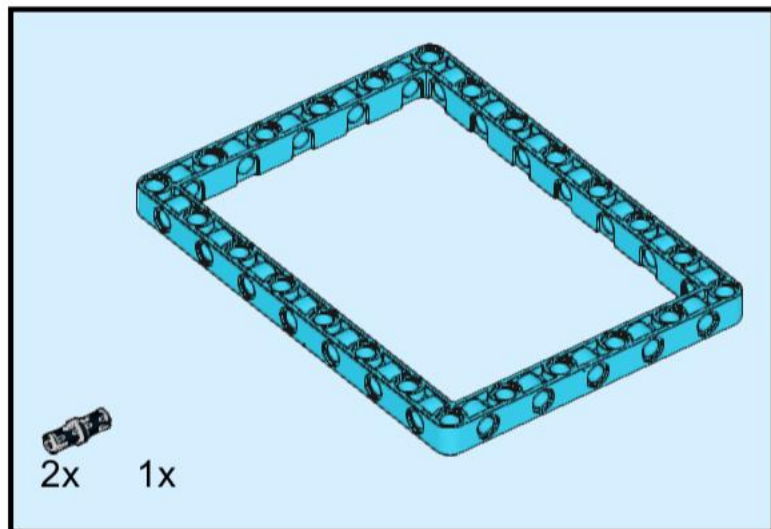

2

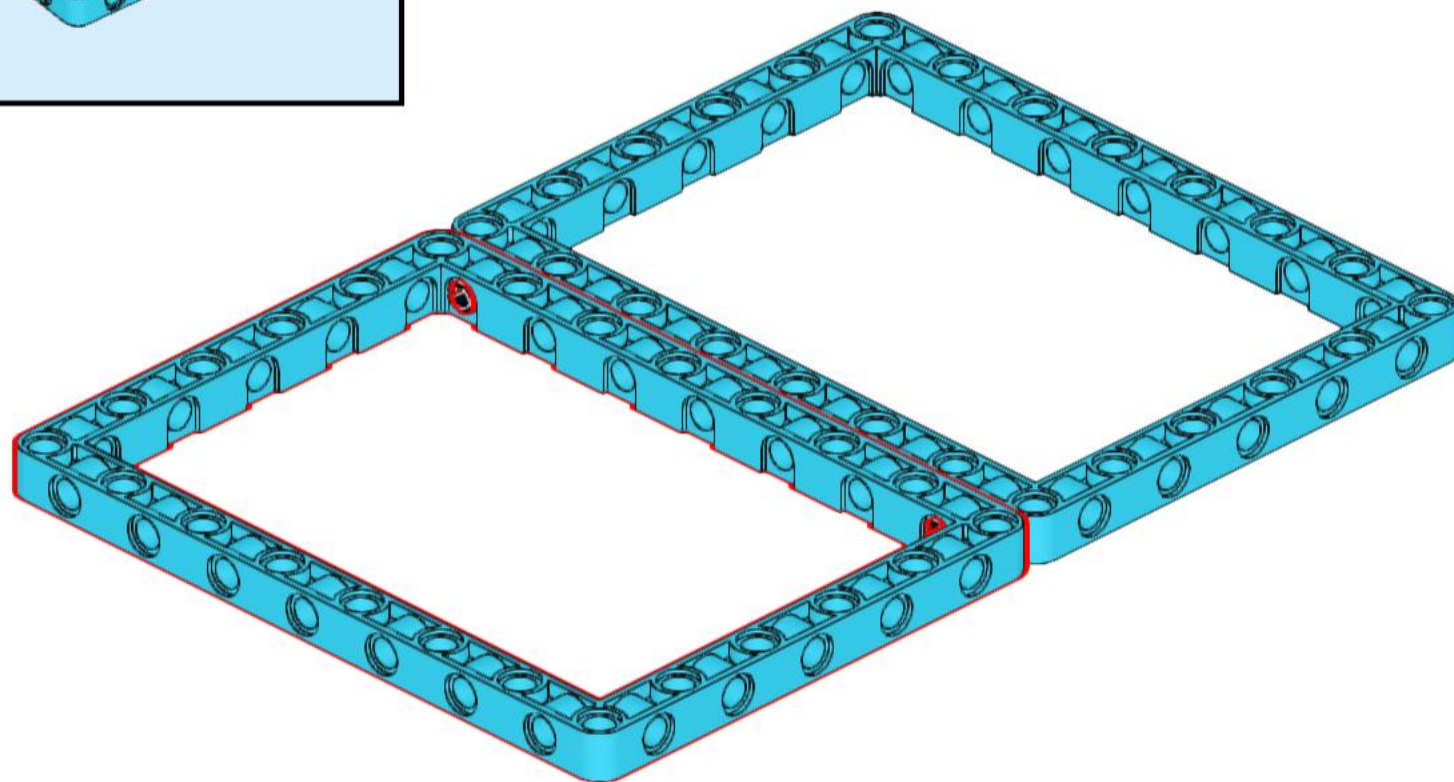
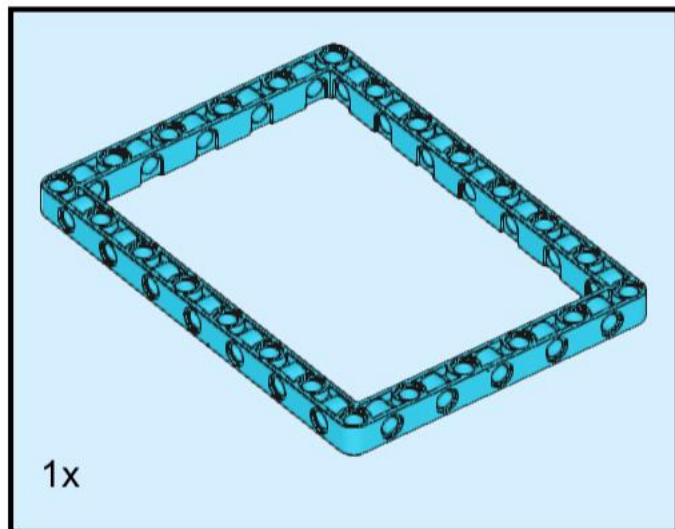

3

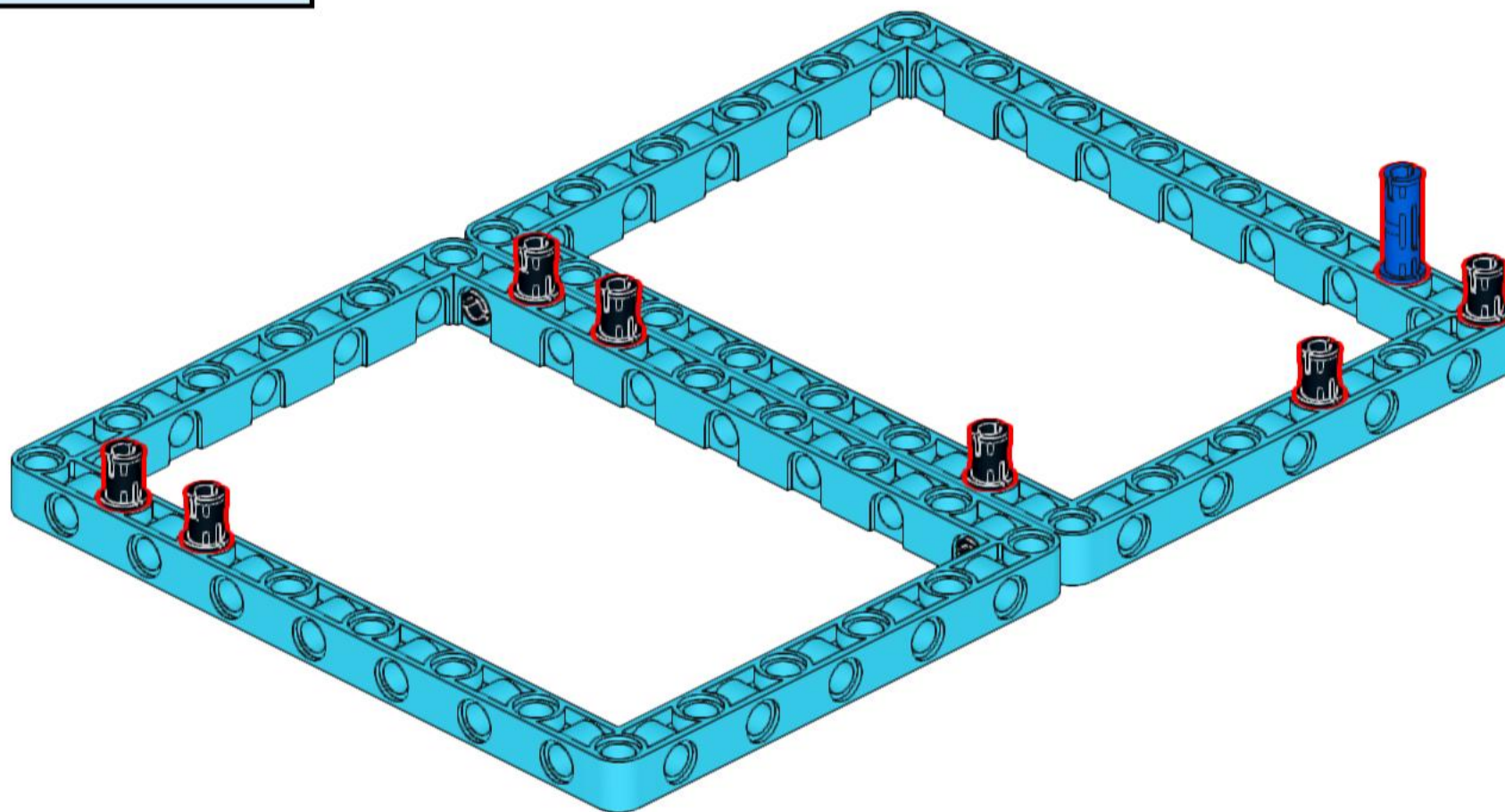
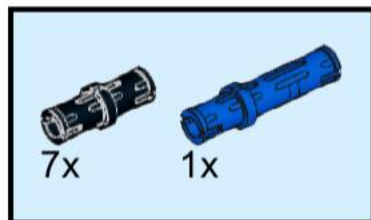

4

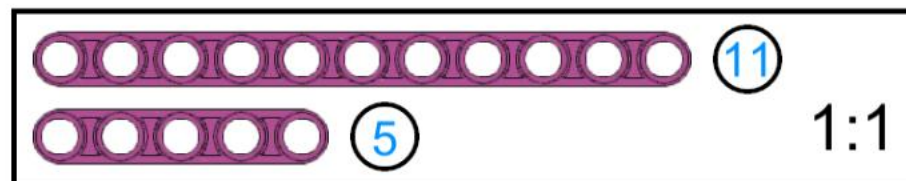
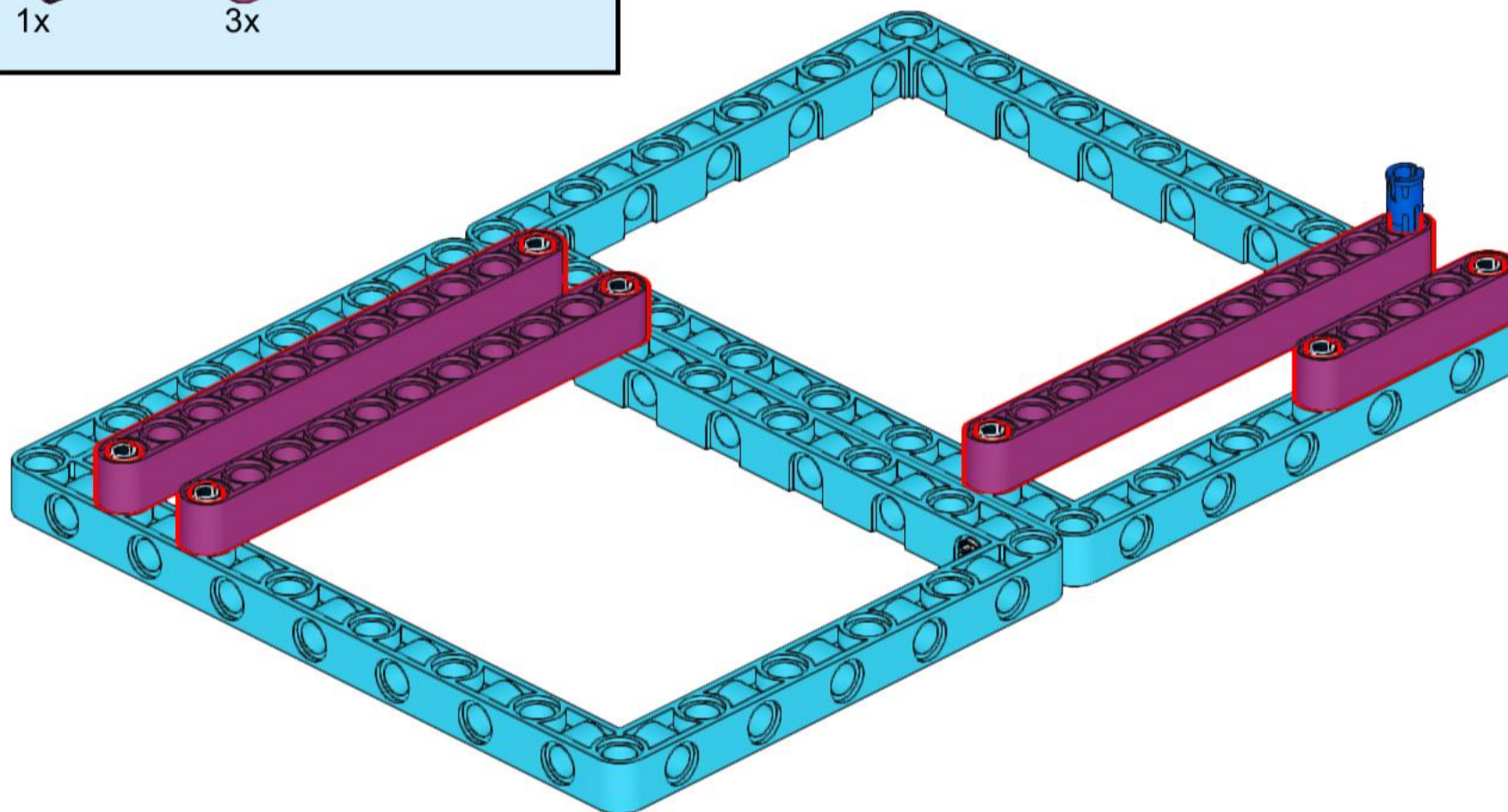
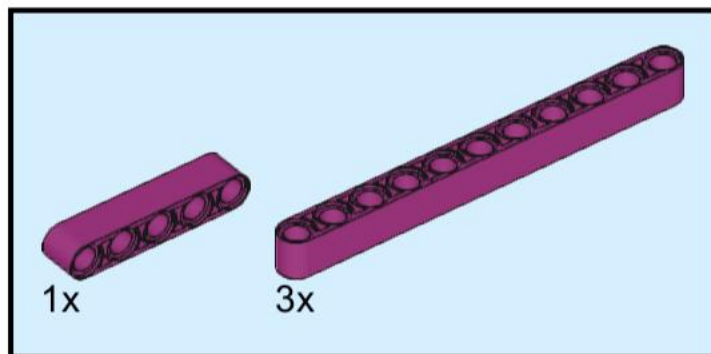

5

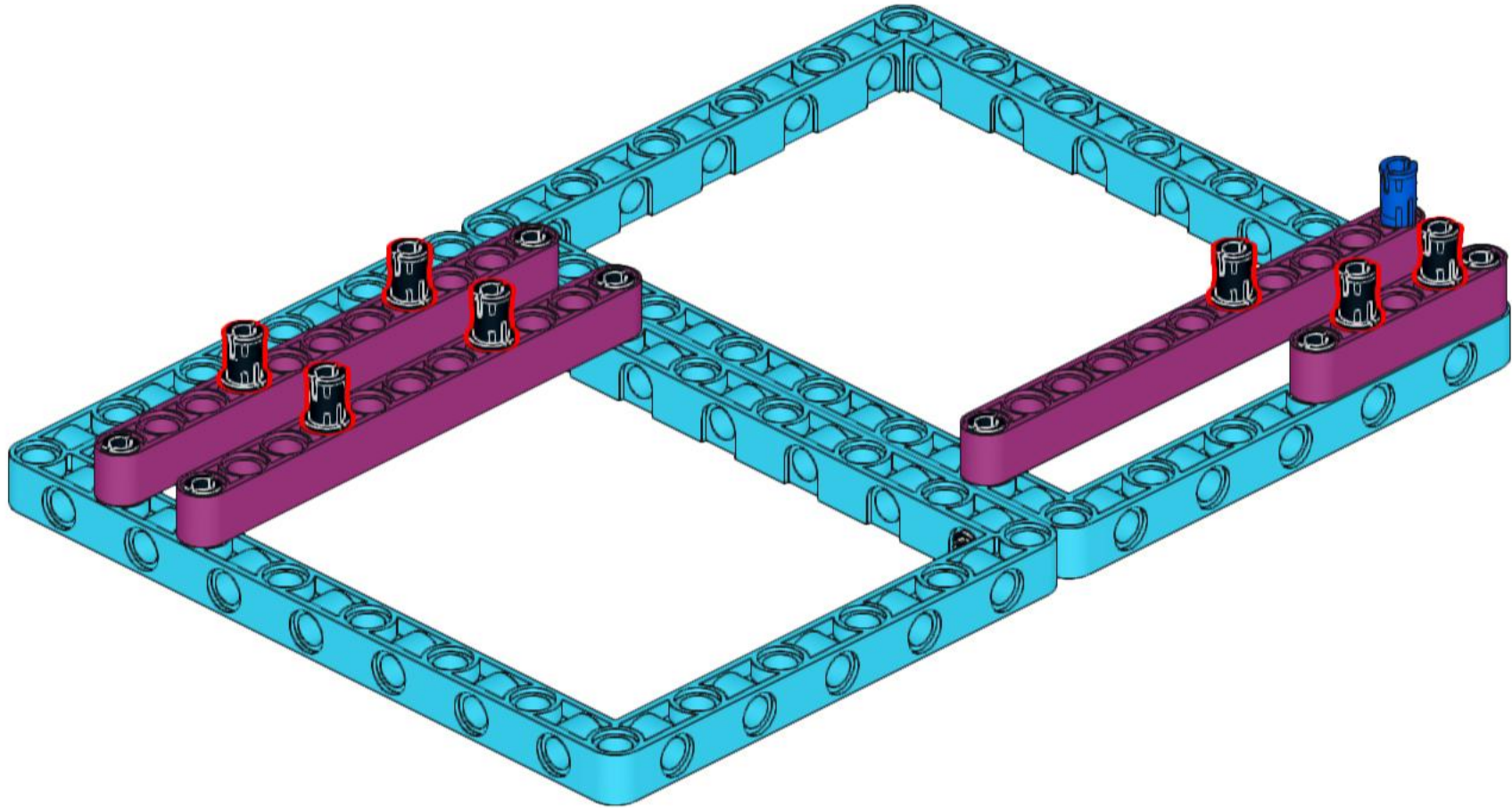

6

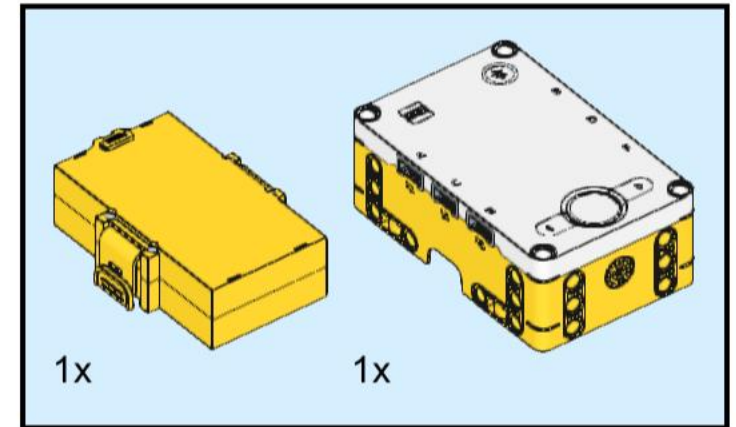
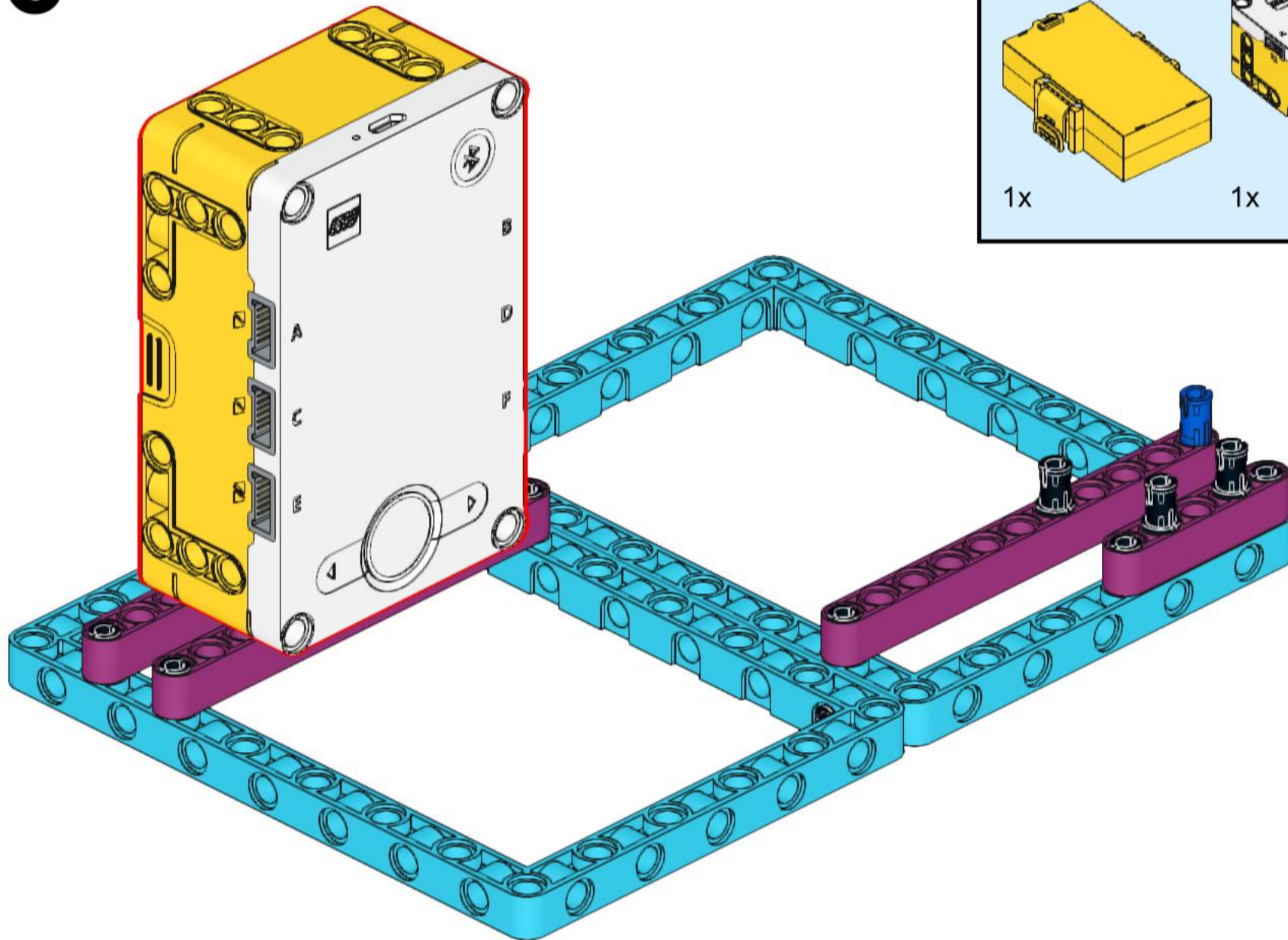

7

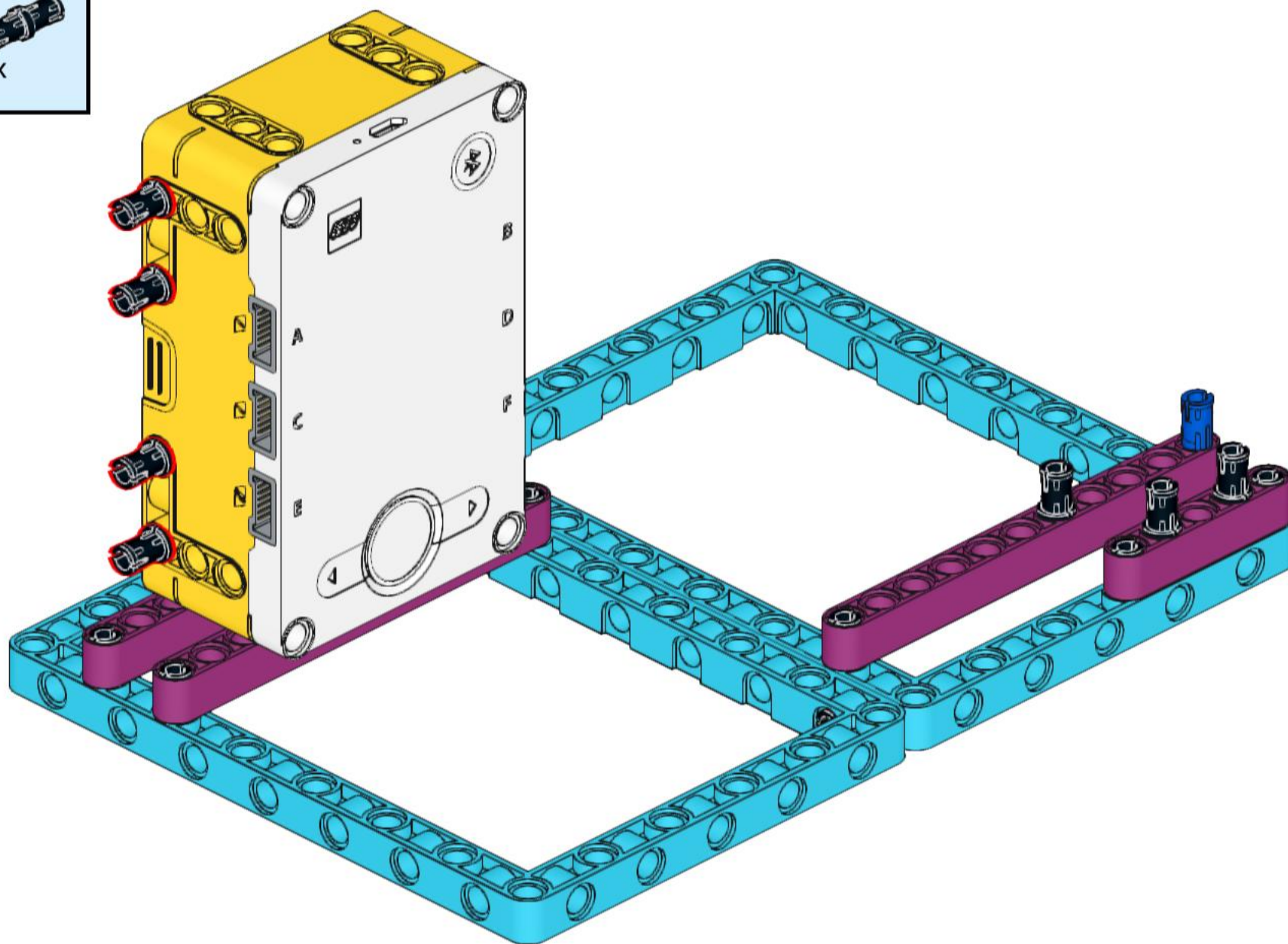

8

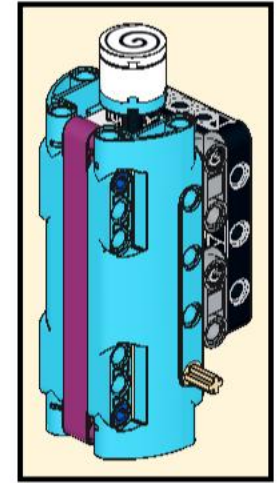
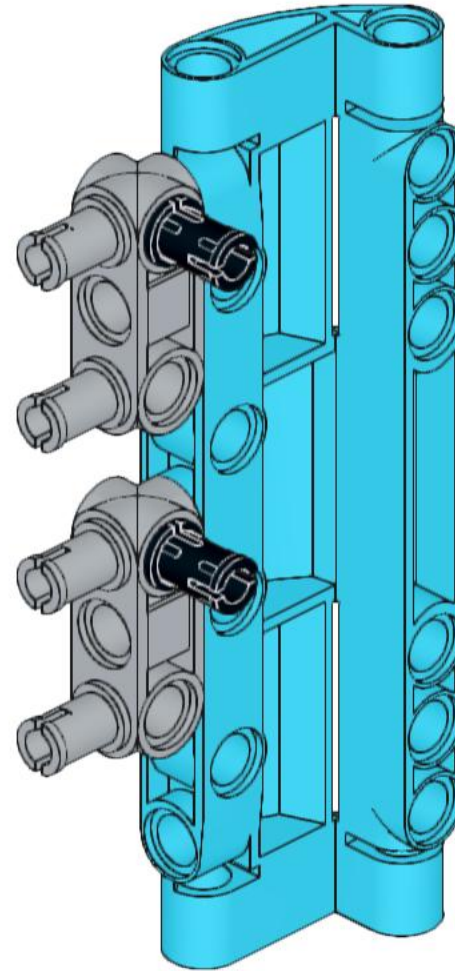
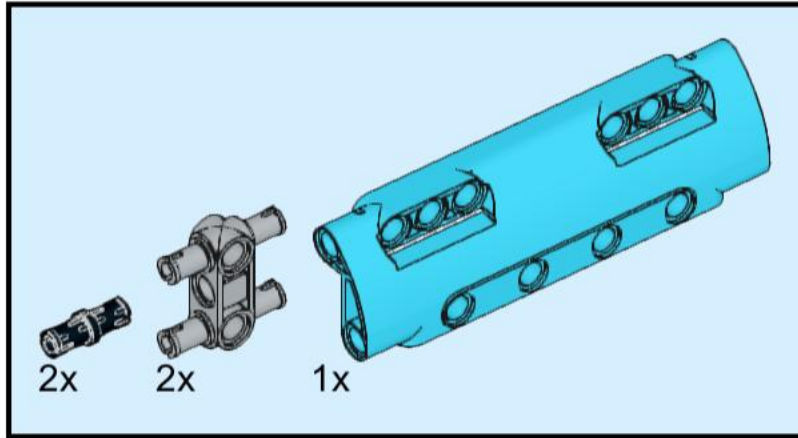

9

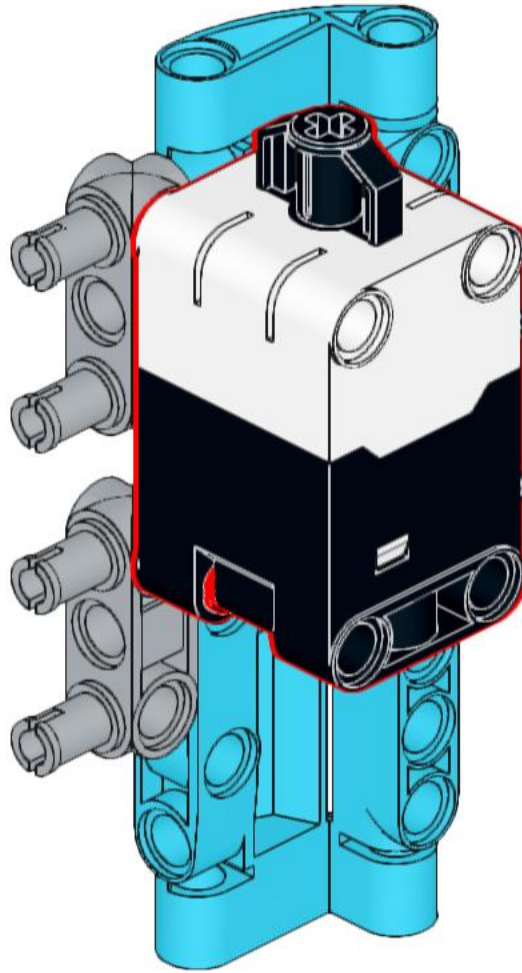
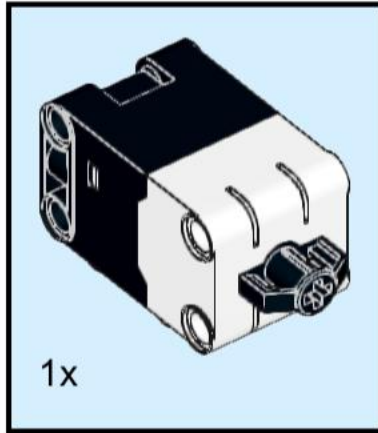

10

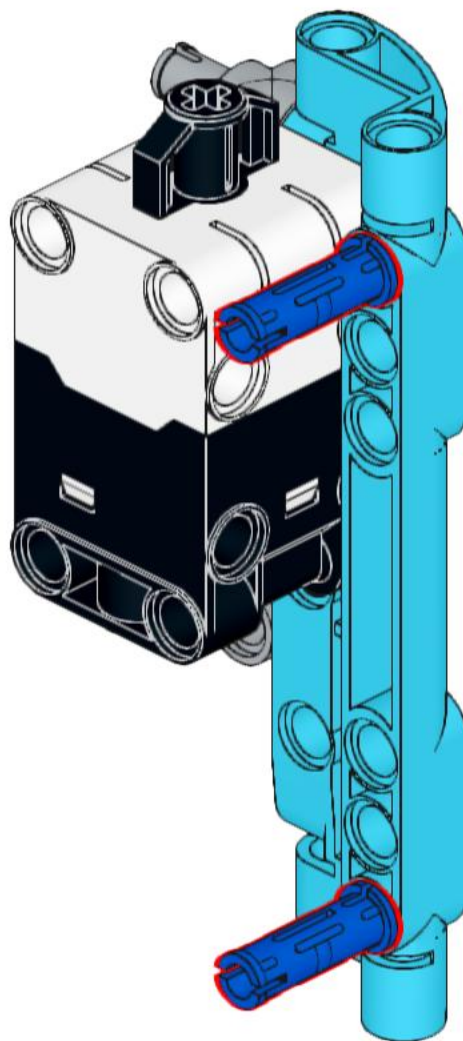
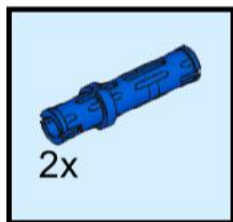

11

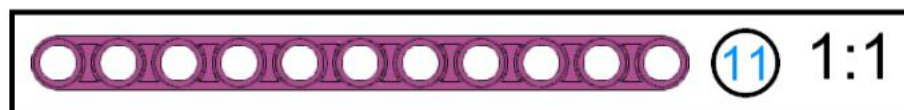
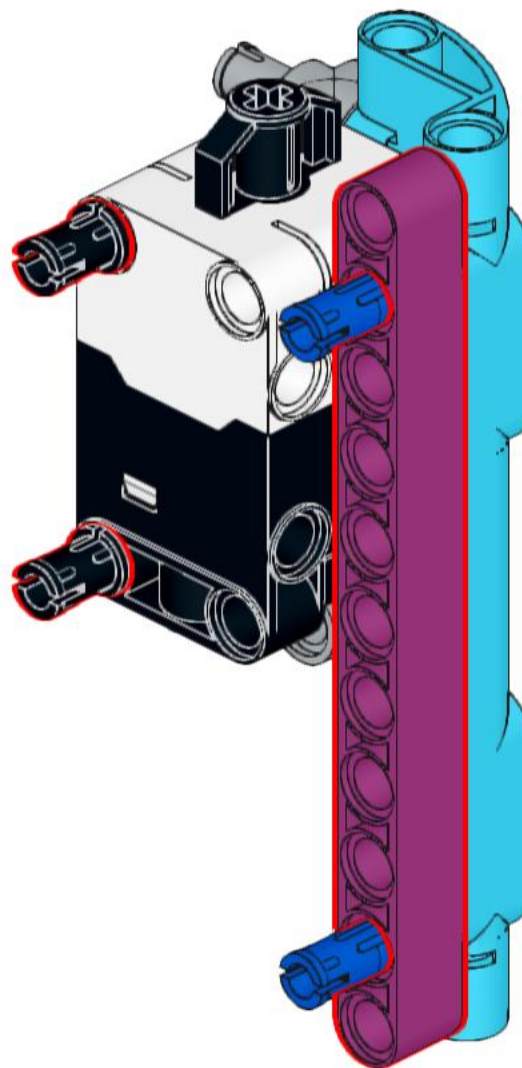
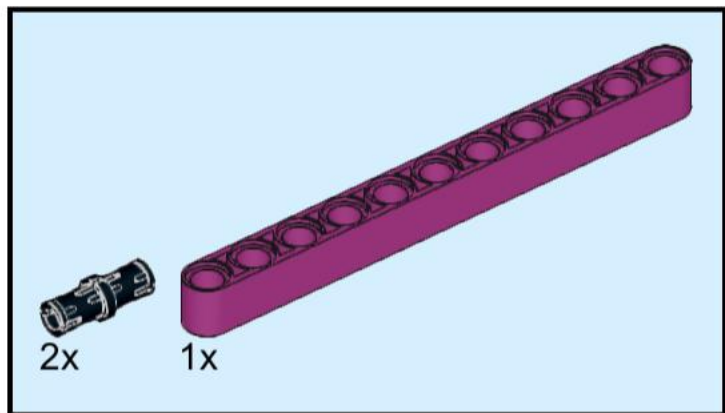

12

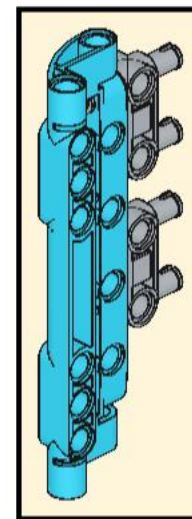
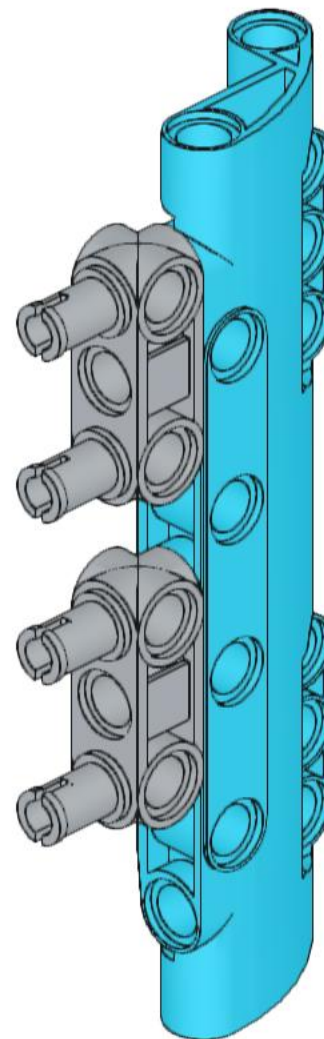
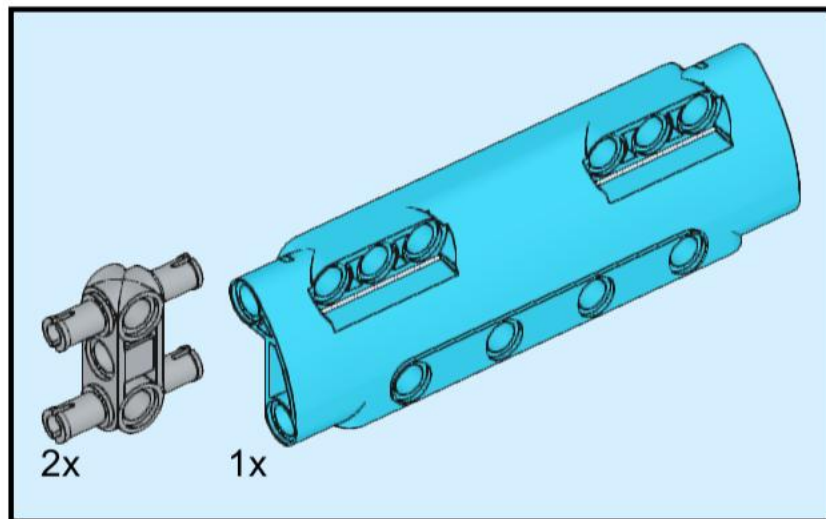

13

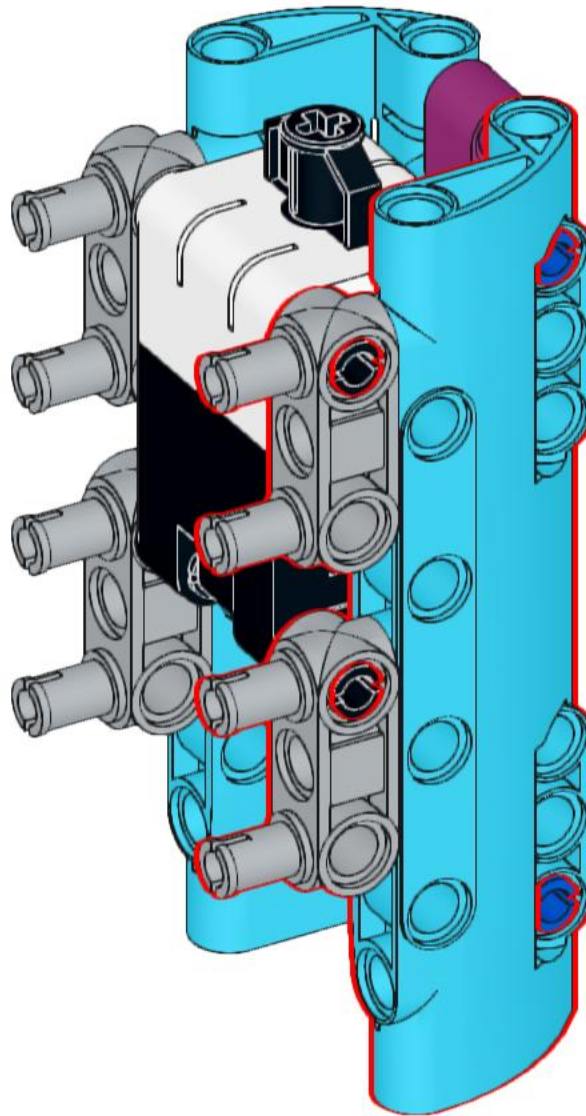

14

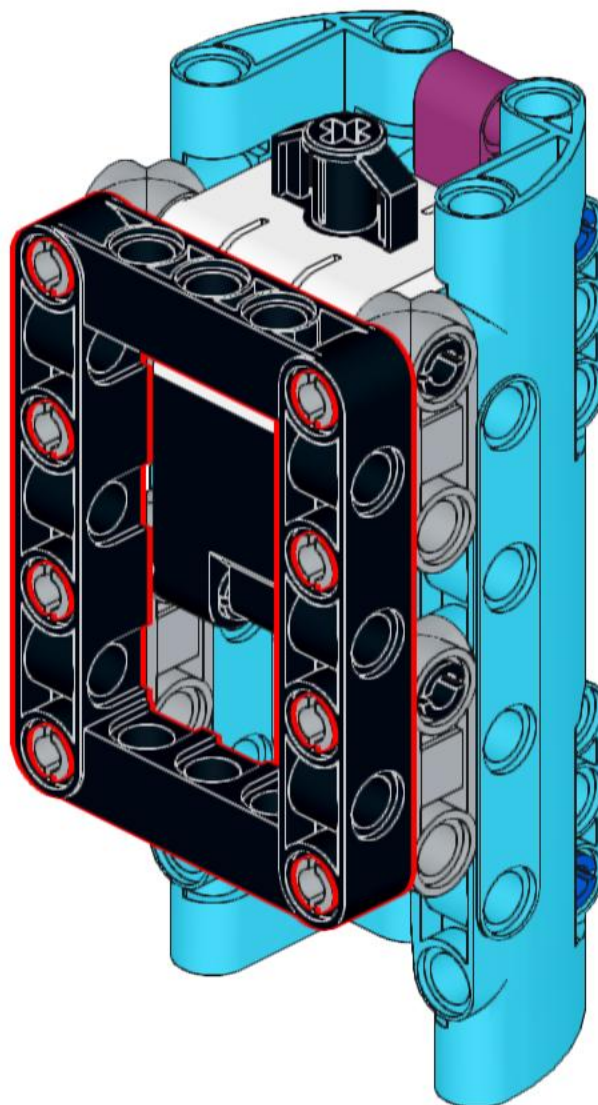
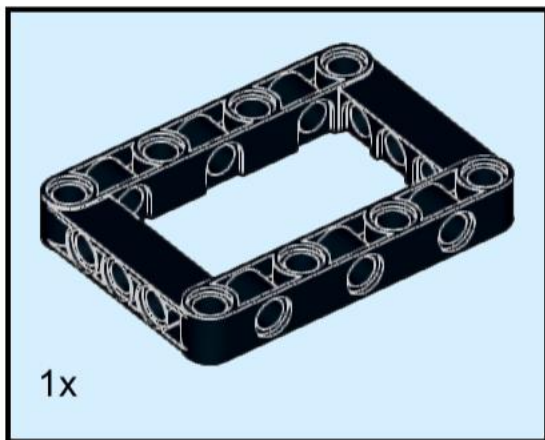

15

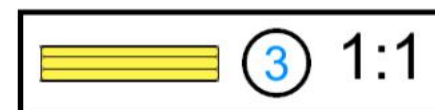
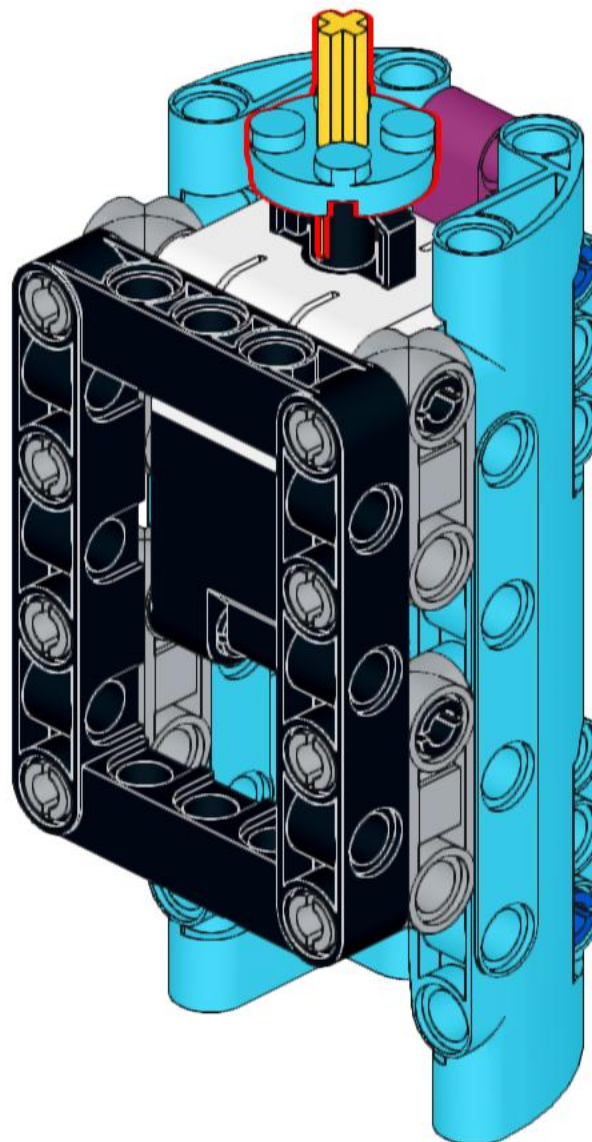
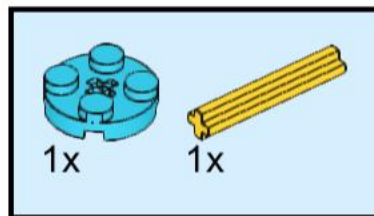

16

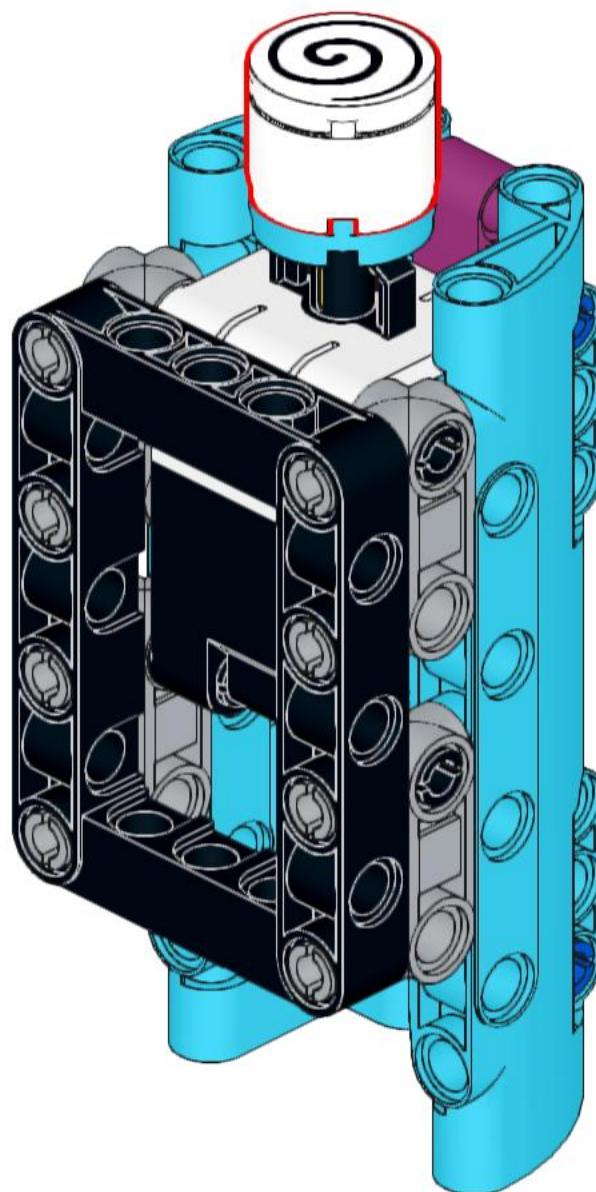
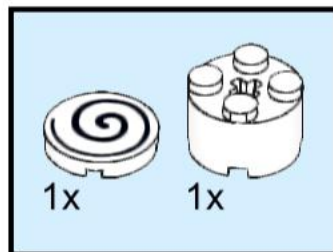

17

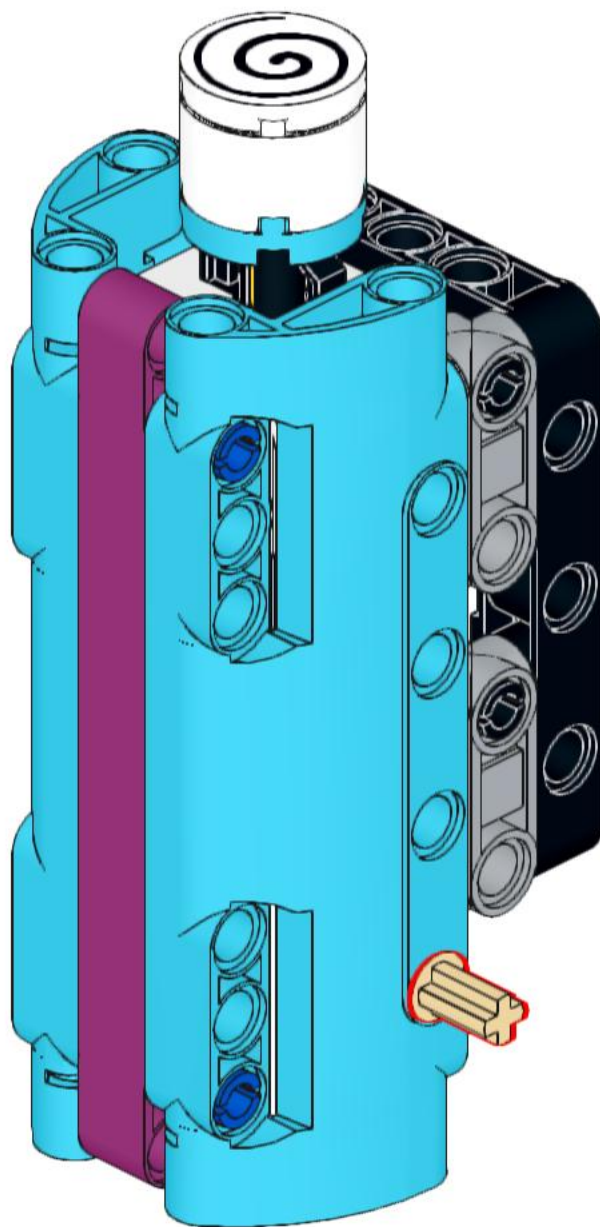
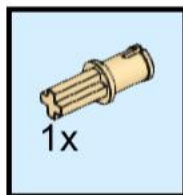

18

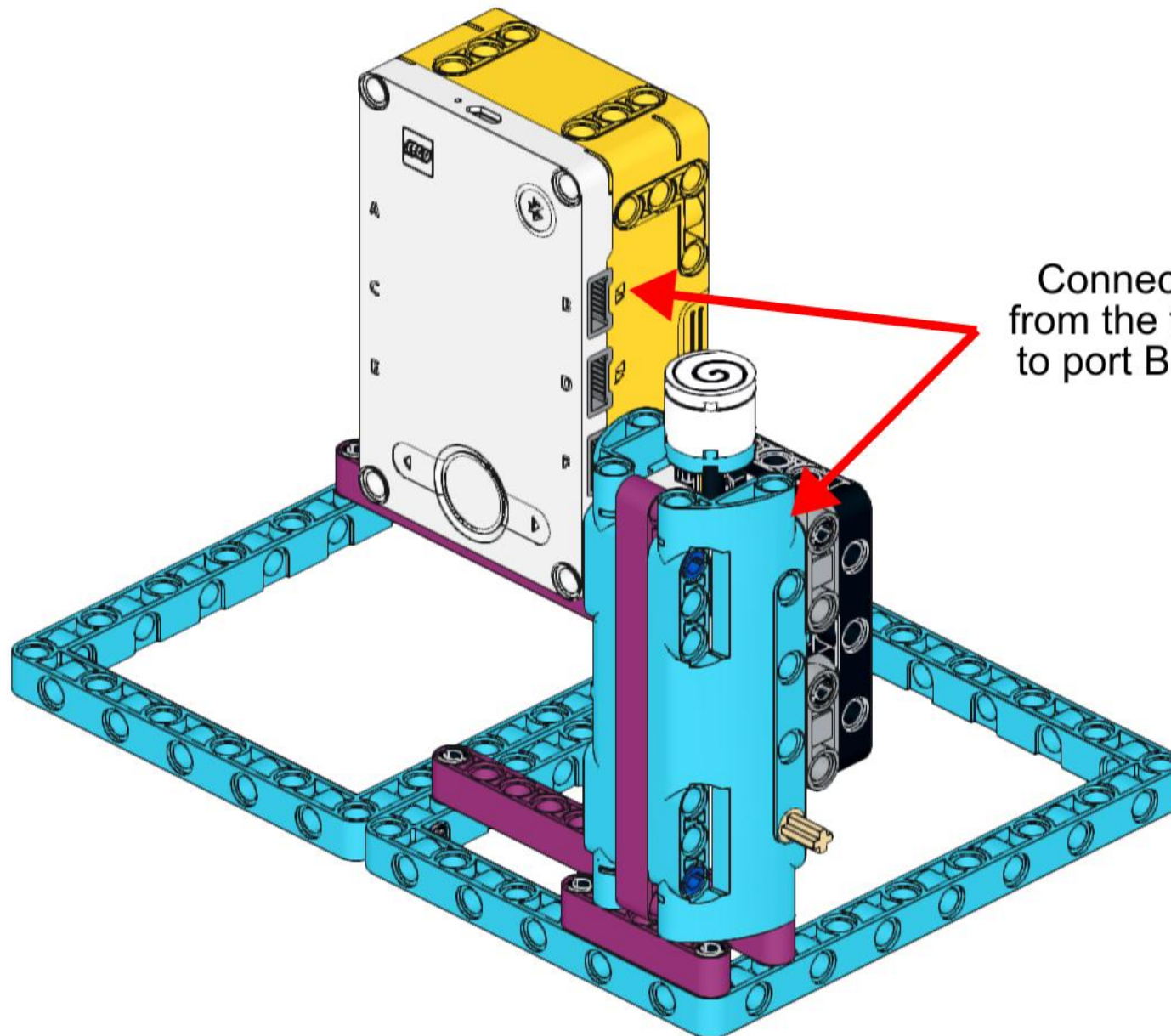

Connect the cable from the force sensor to port B on the hub.

19

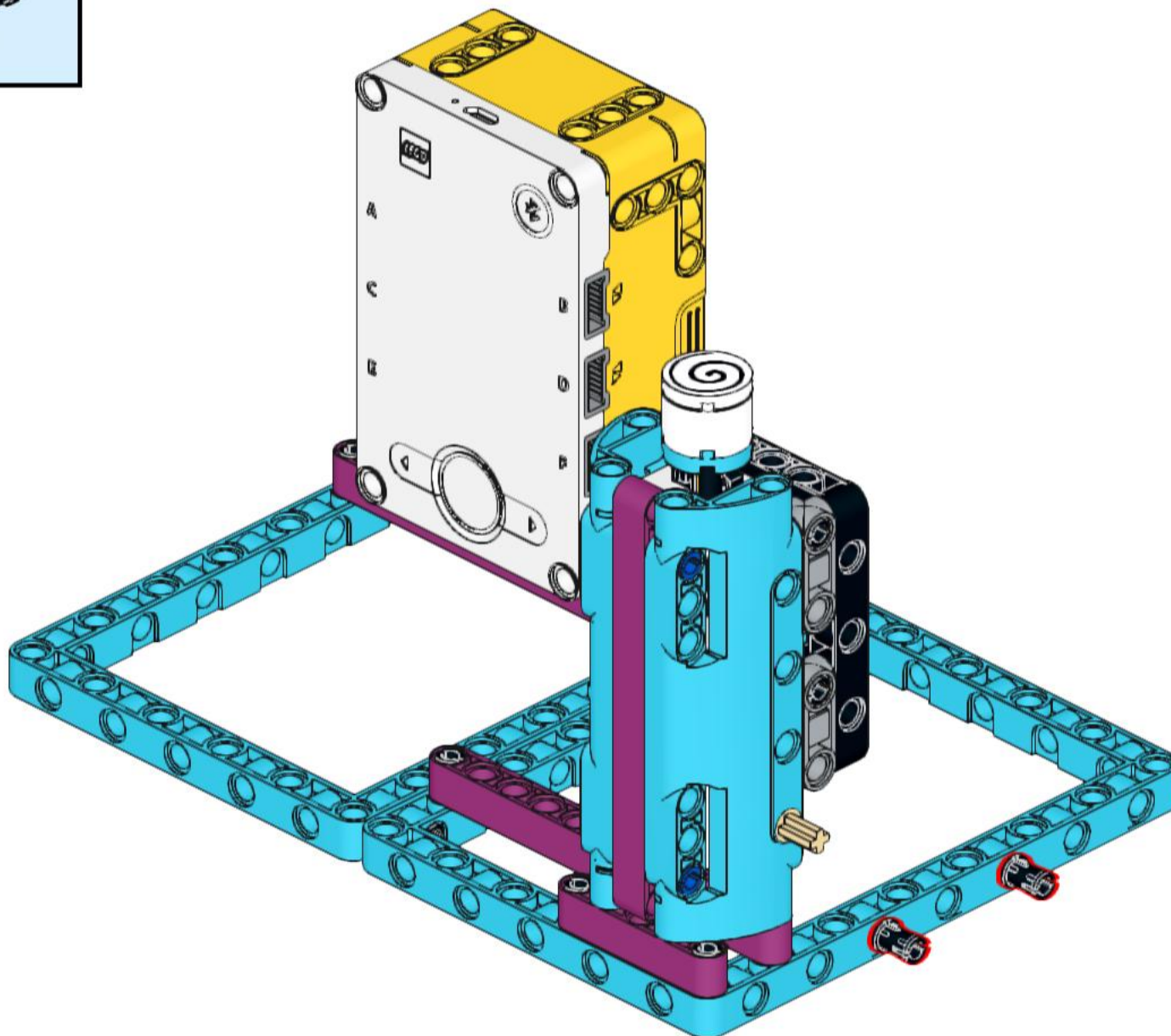

20

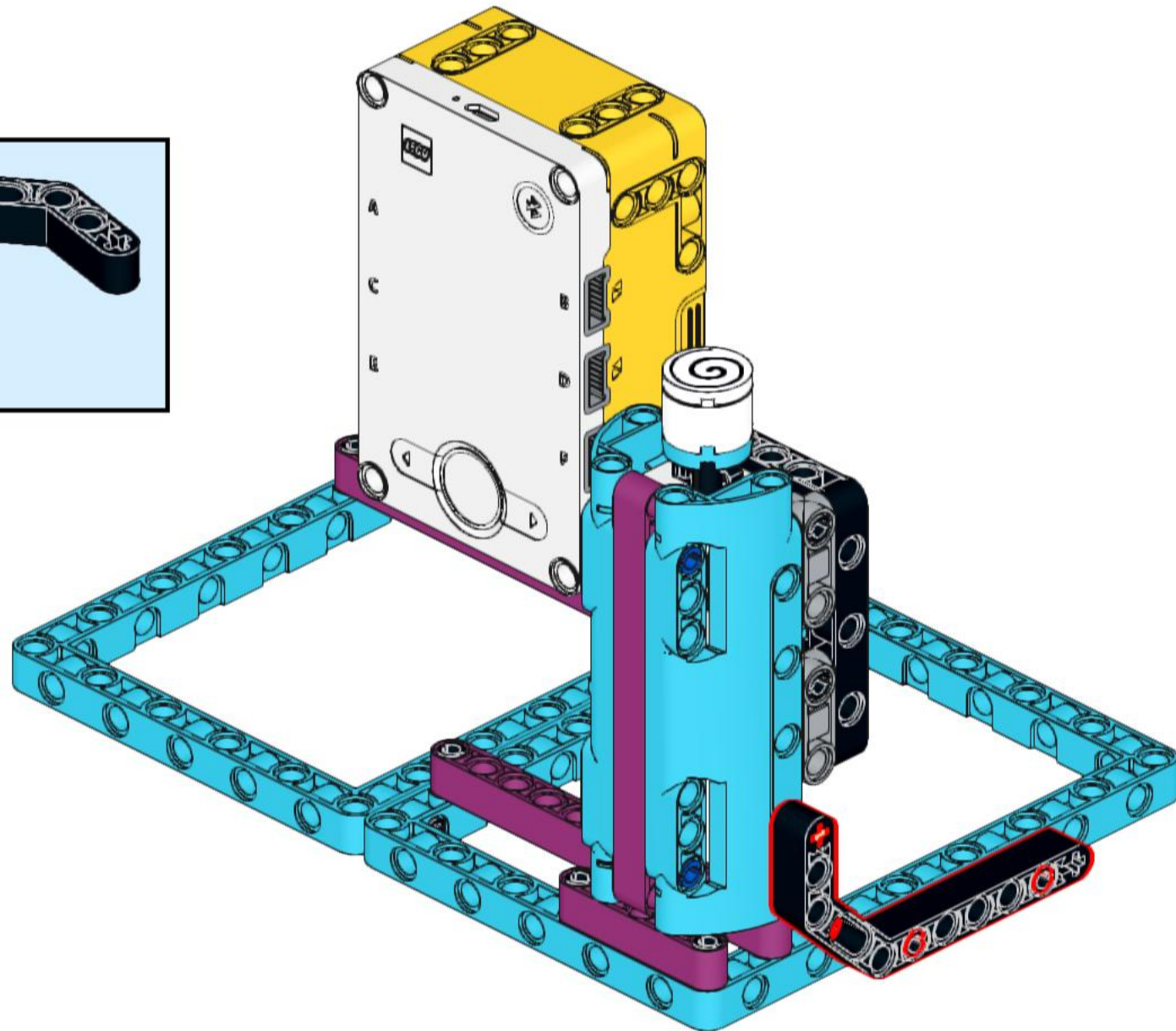
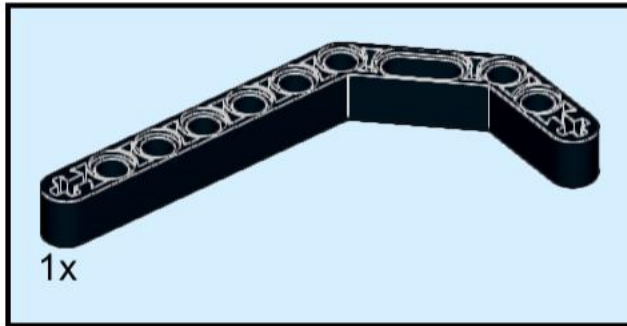

21

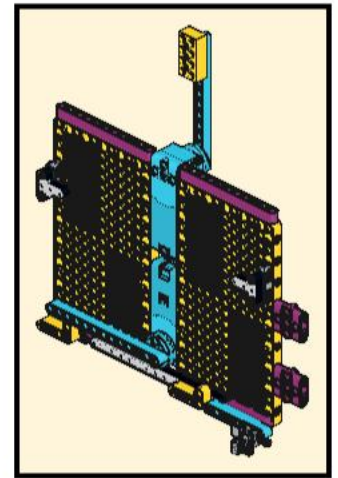
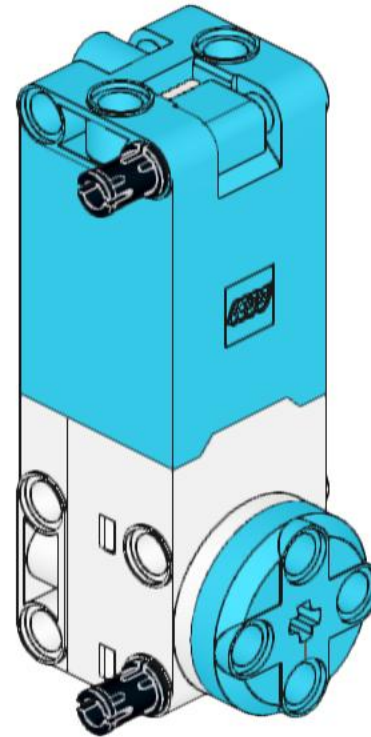
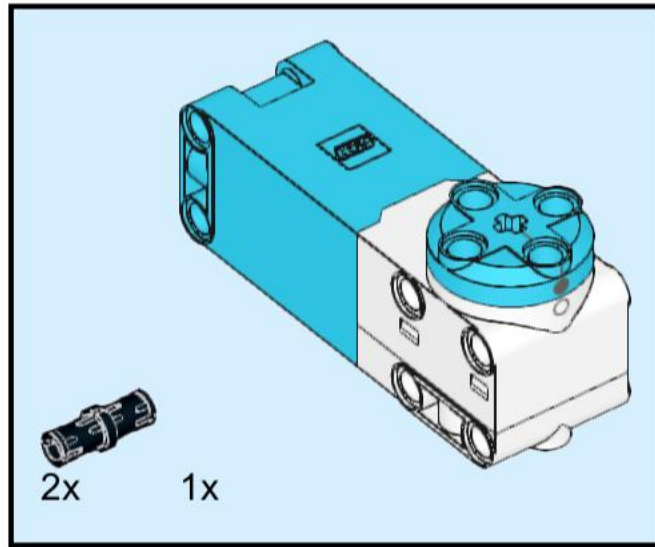

22

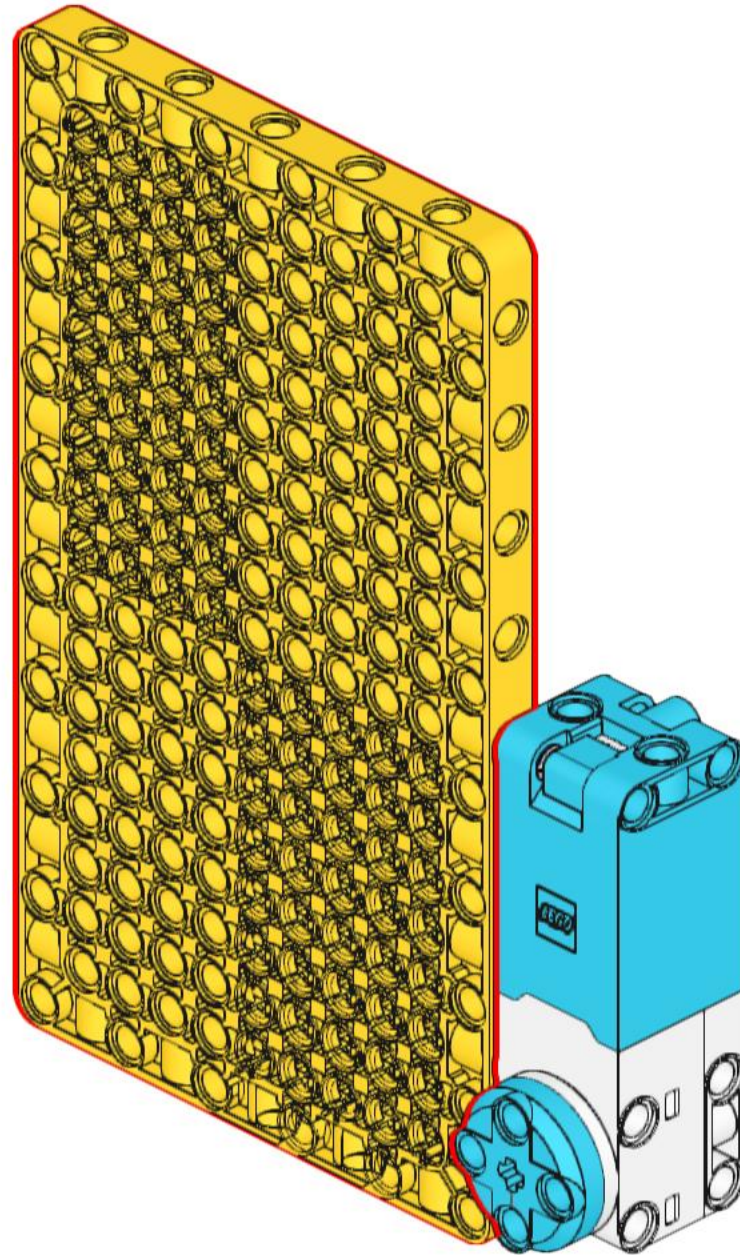
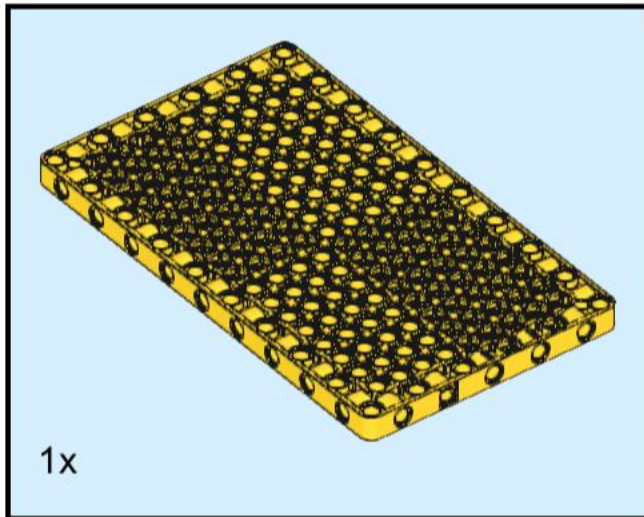

23

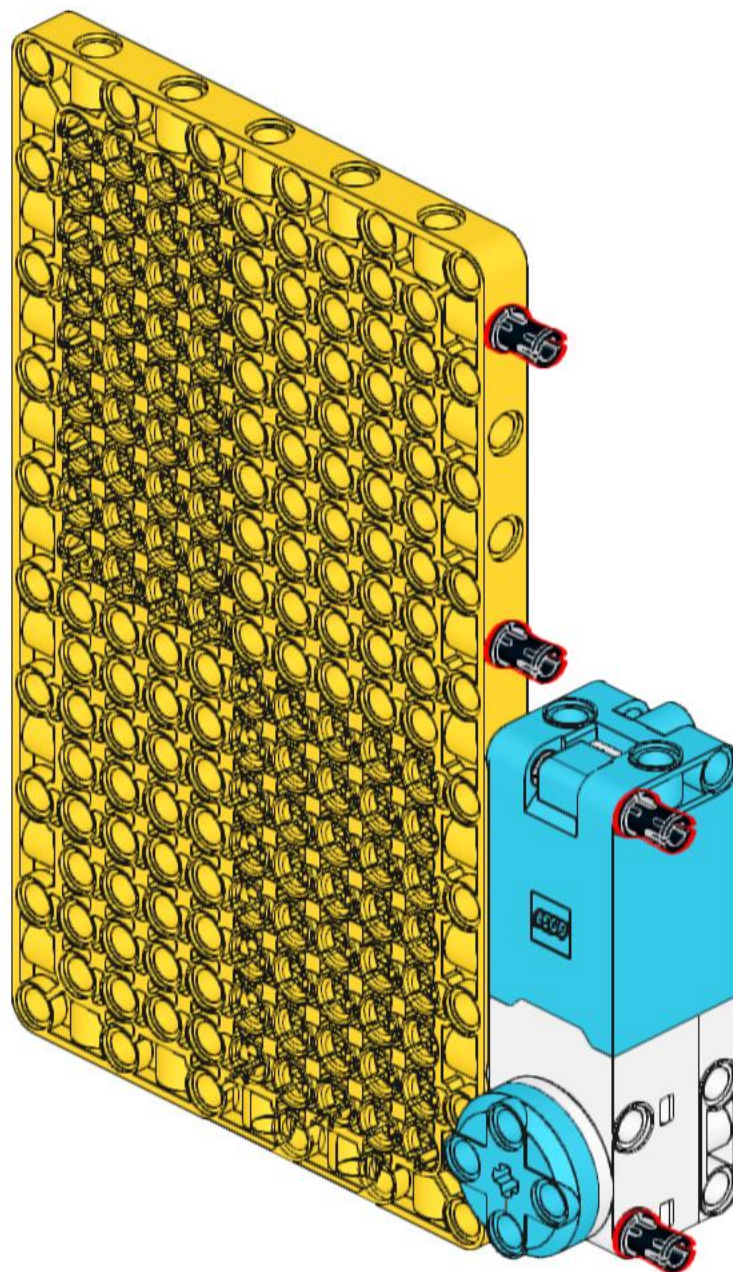

24

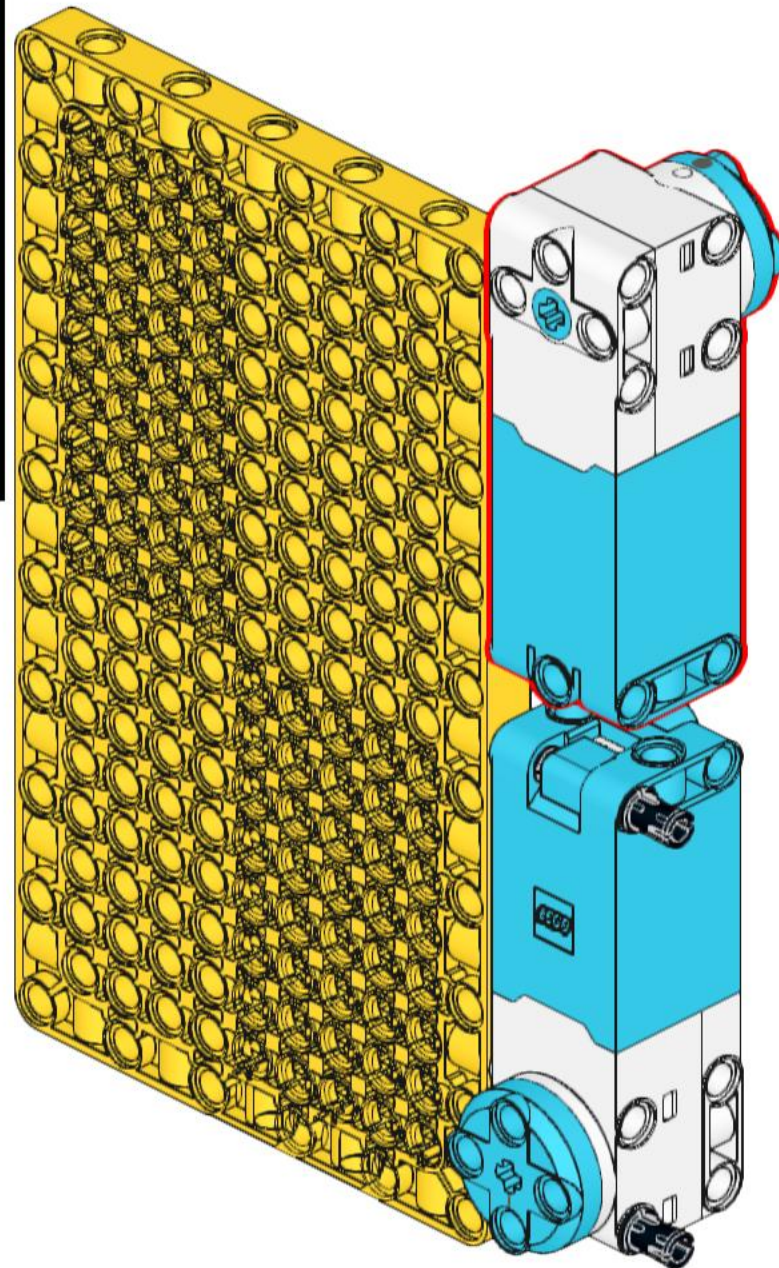
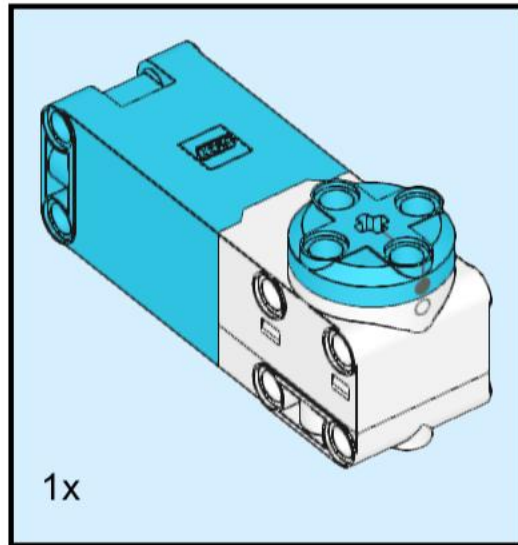

25

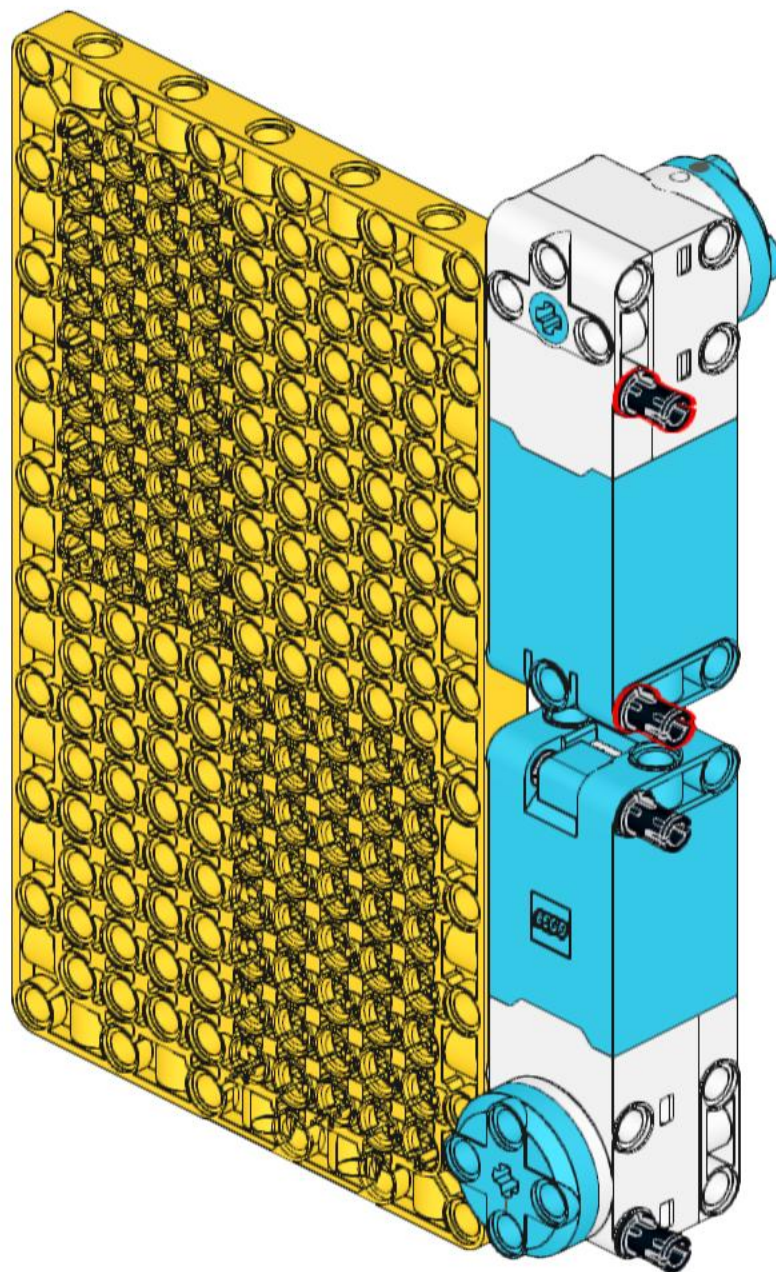

26

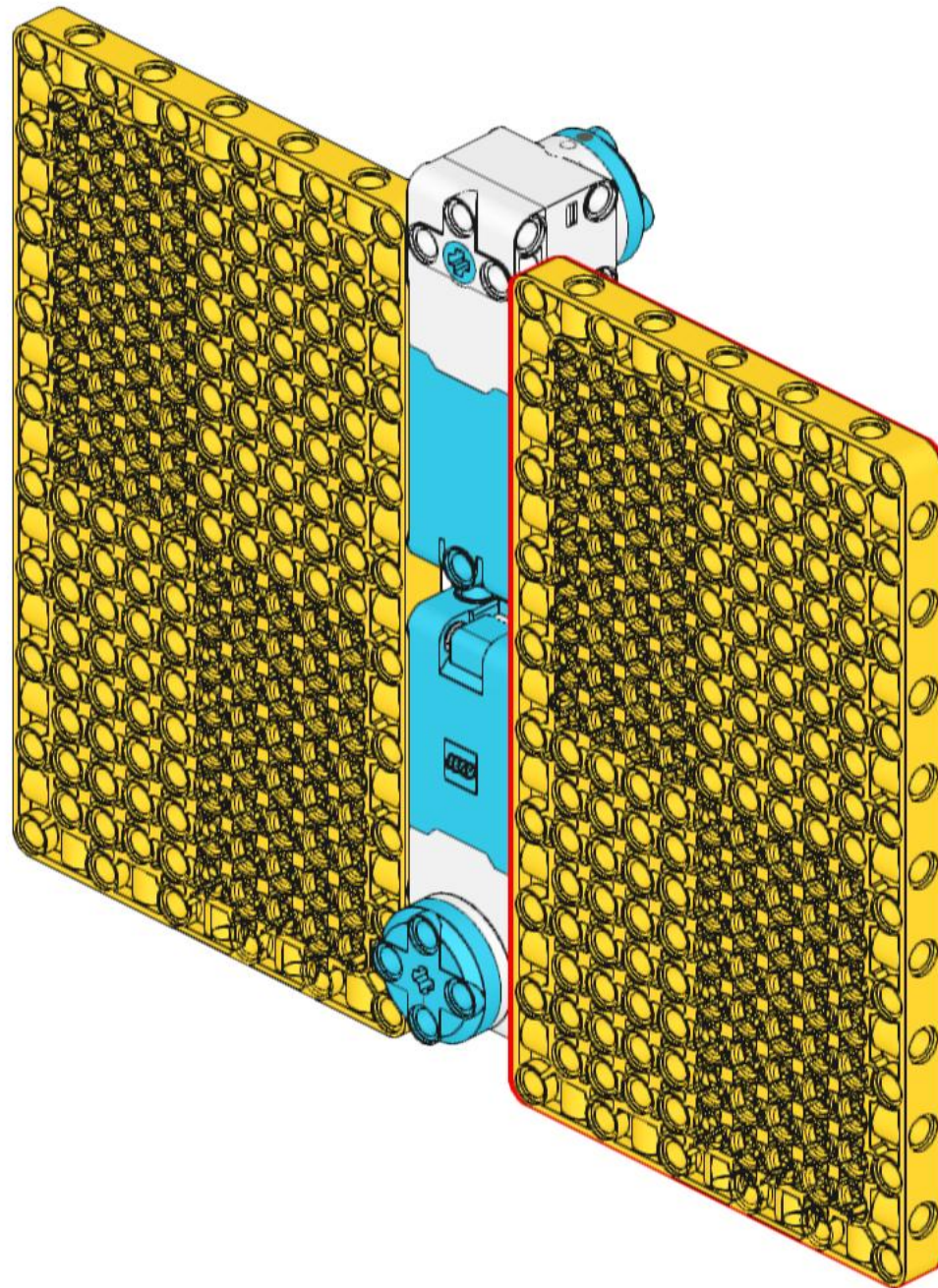
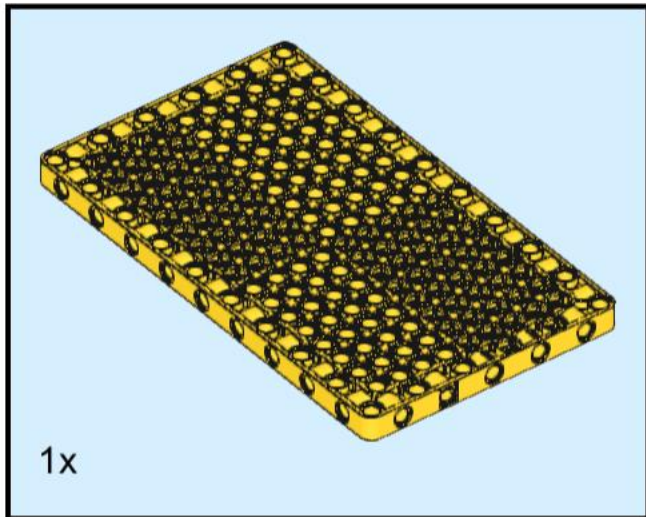

27

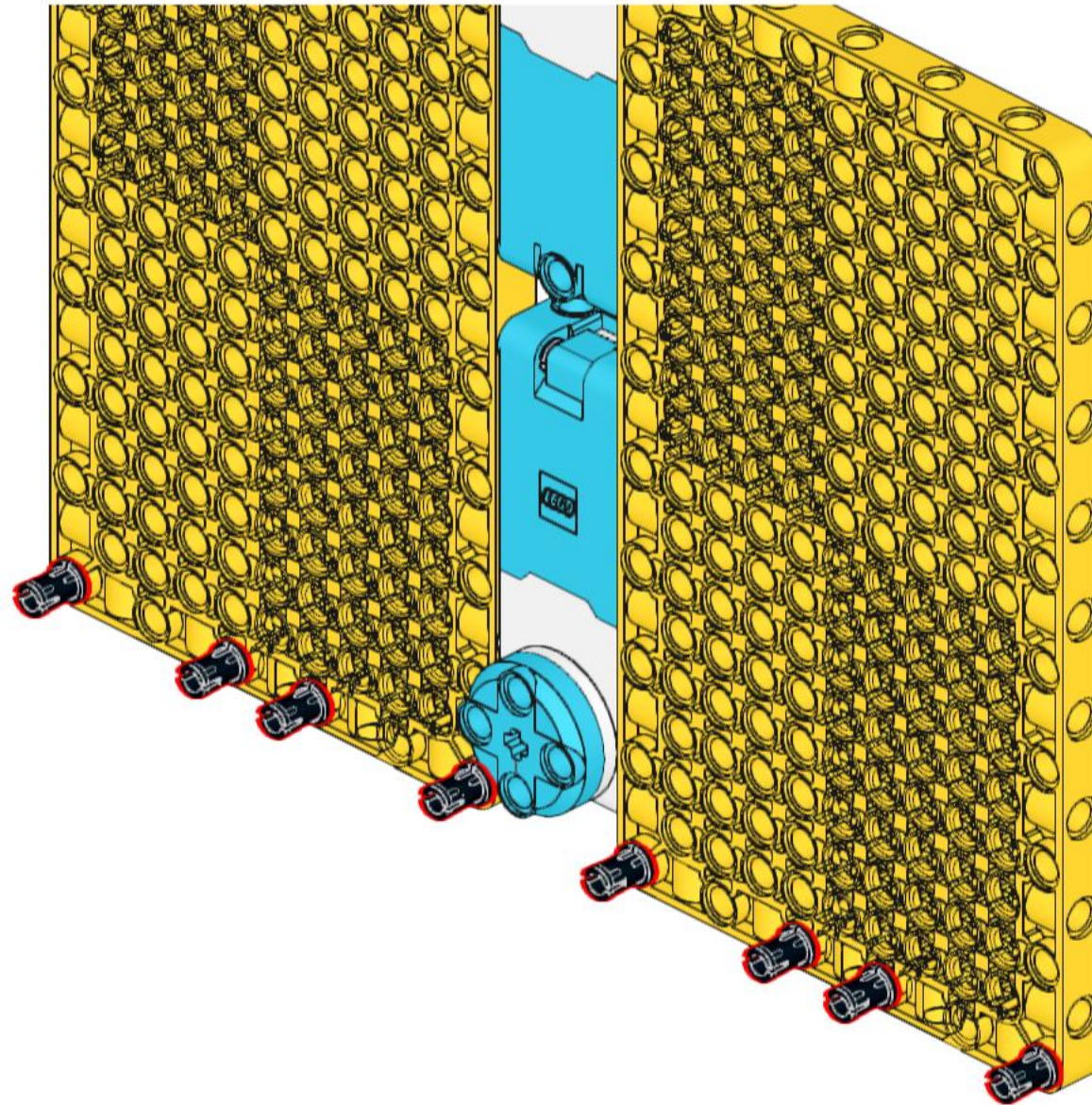

28

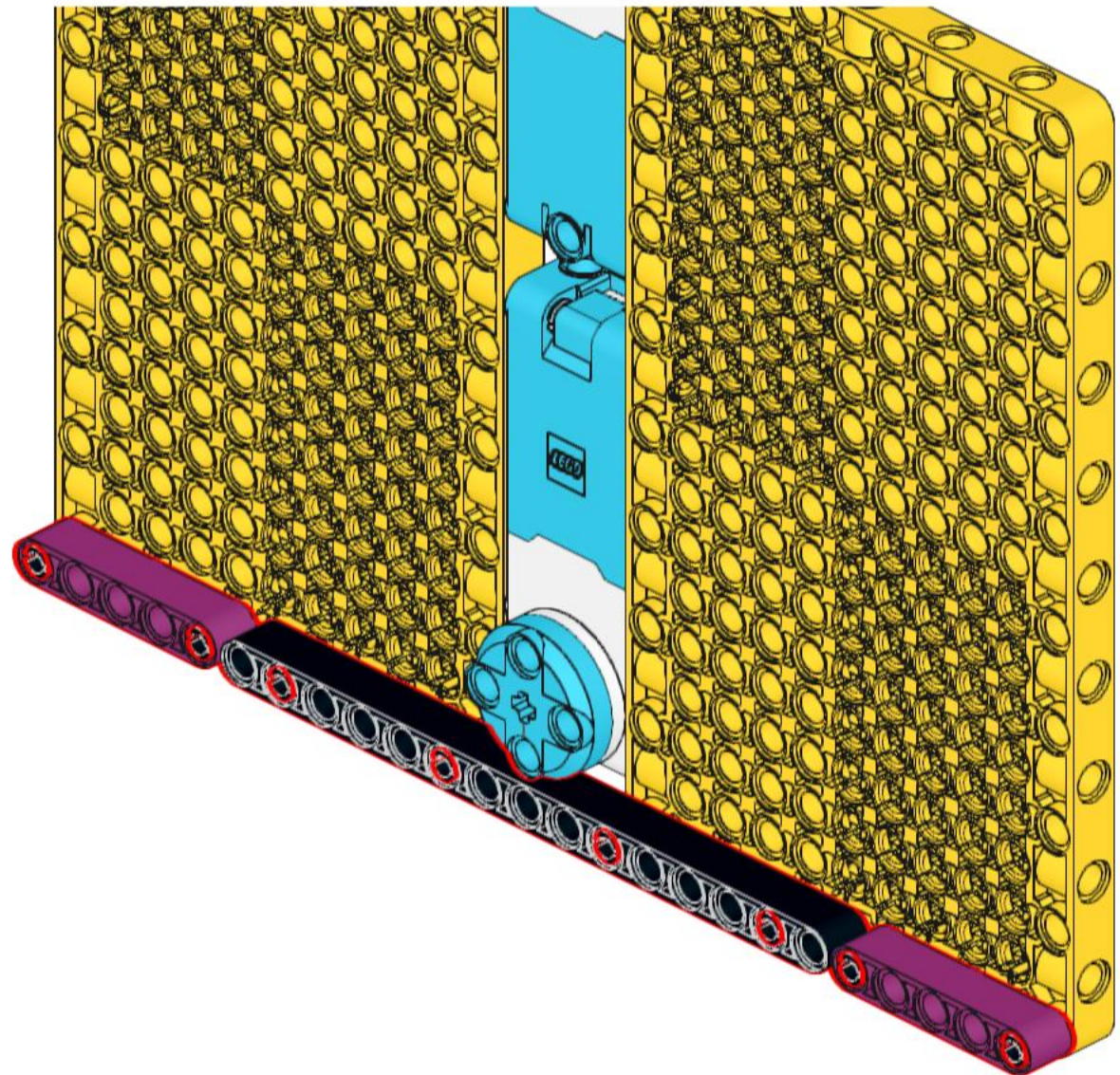
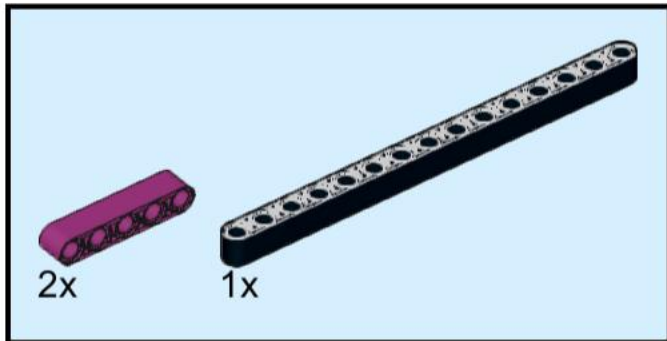

29

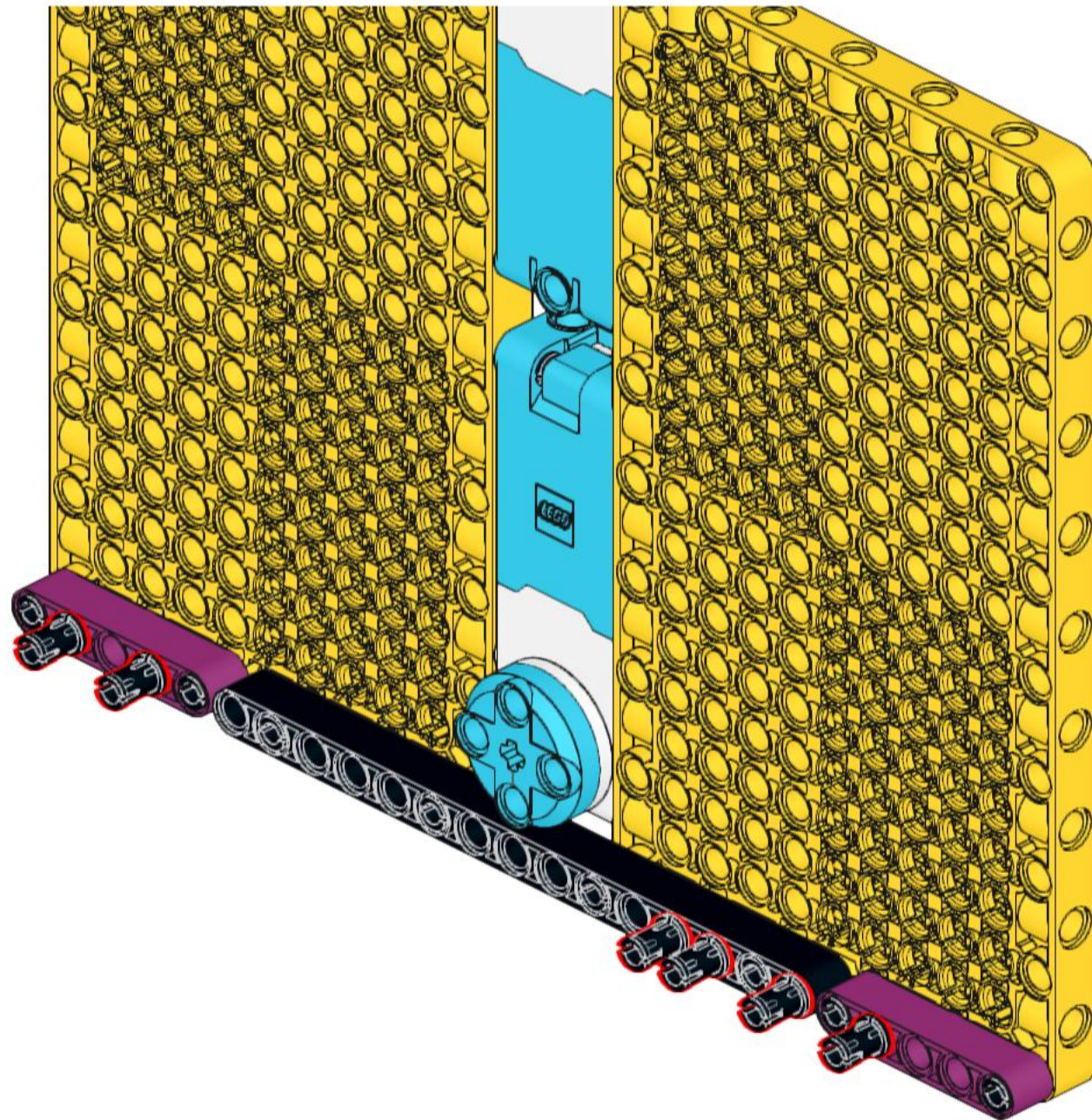

30

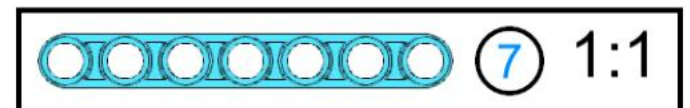
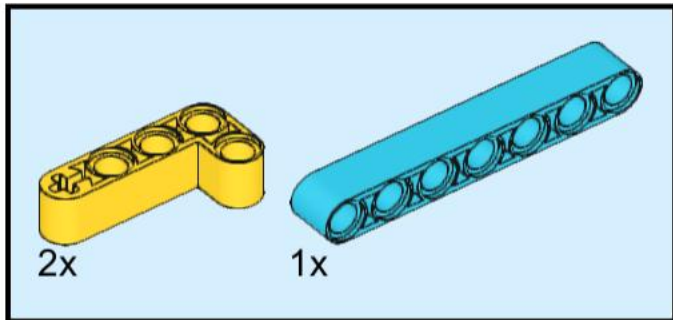

31

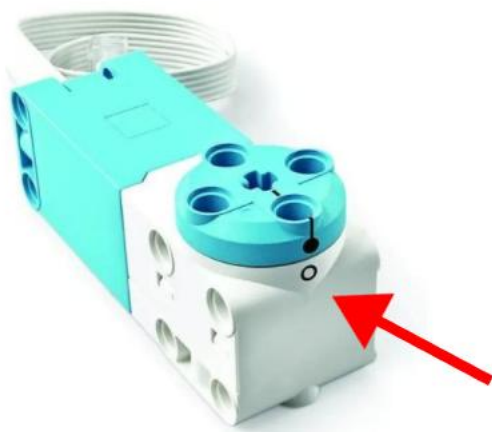
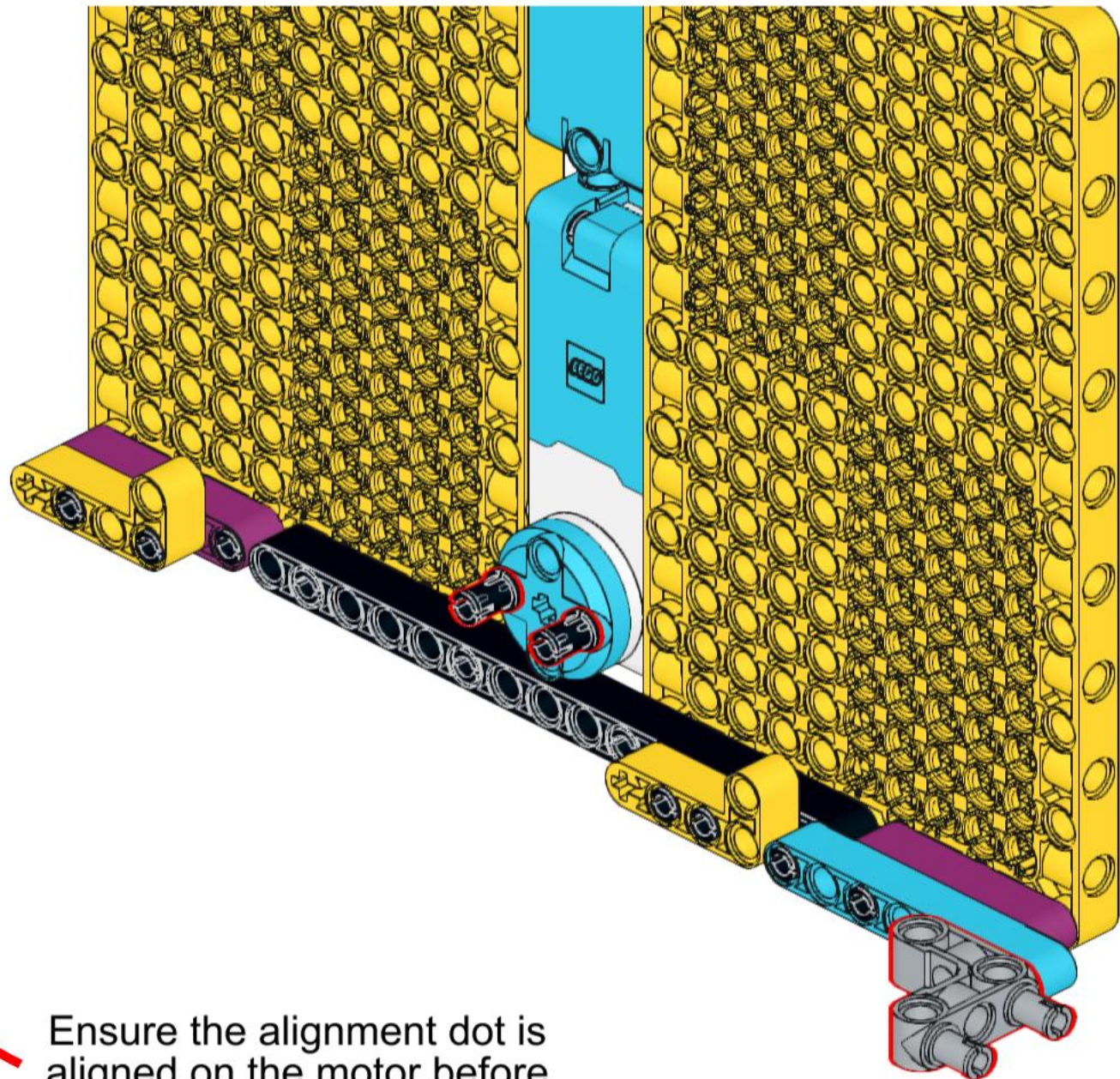
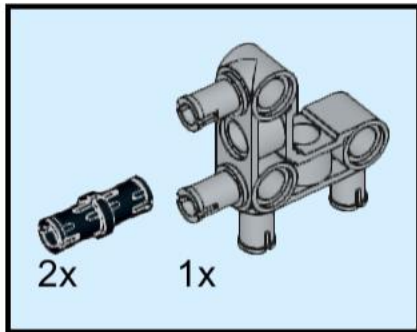

Ensure the alignment dot is aligned on the motor before adding the 2 black pins

32

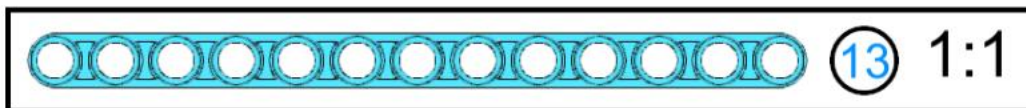
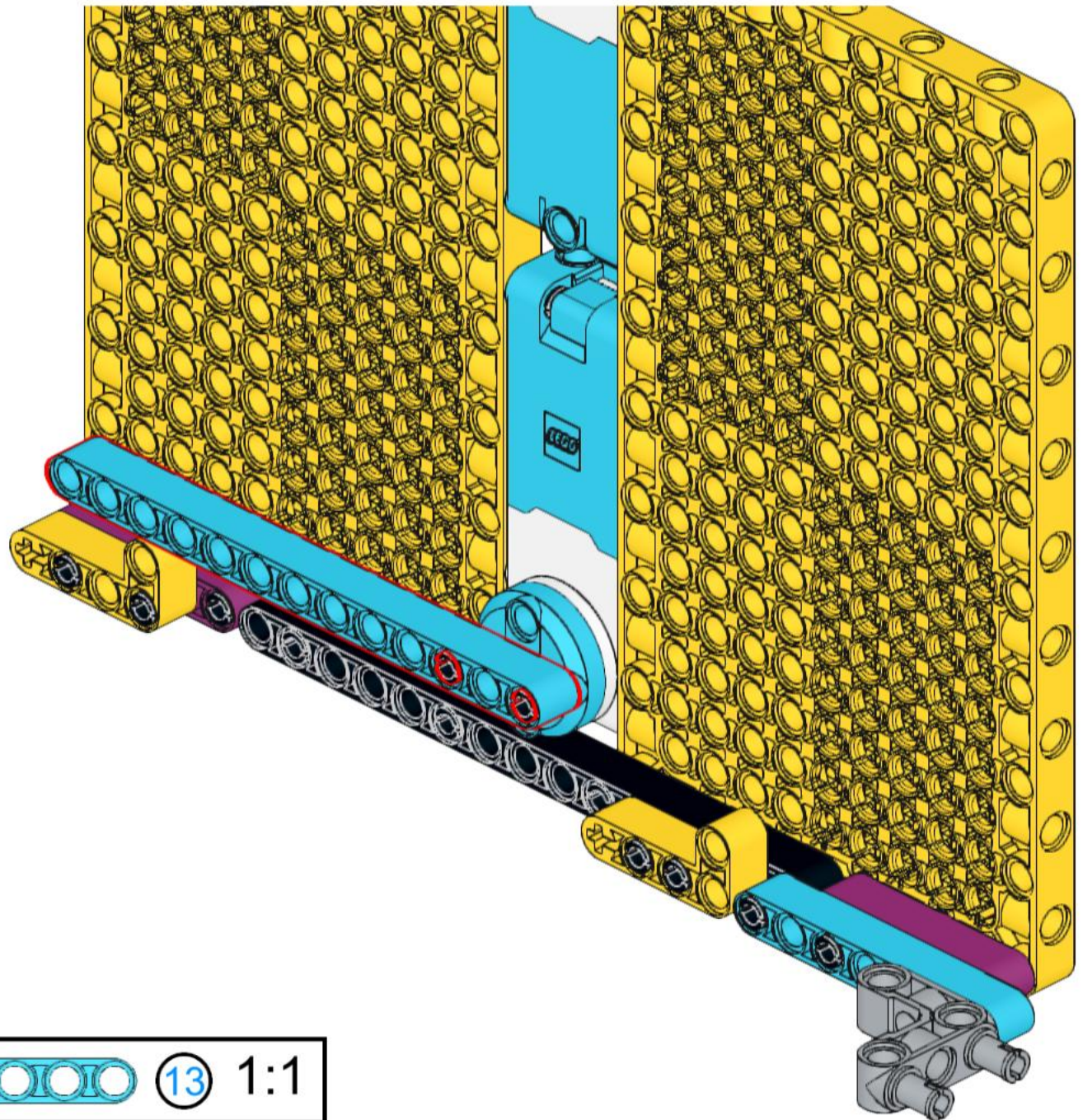
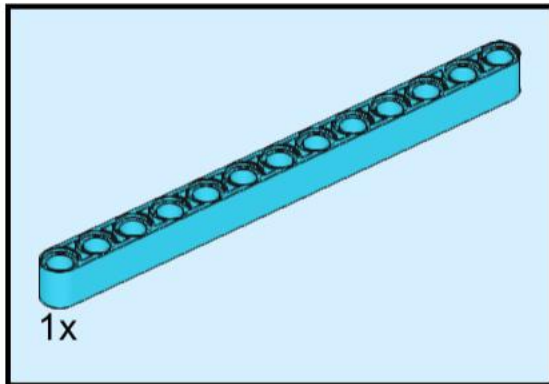

33

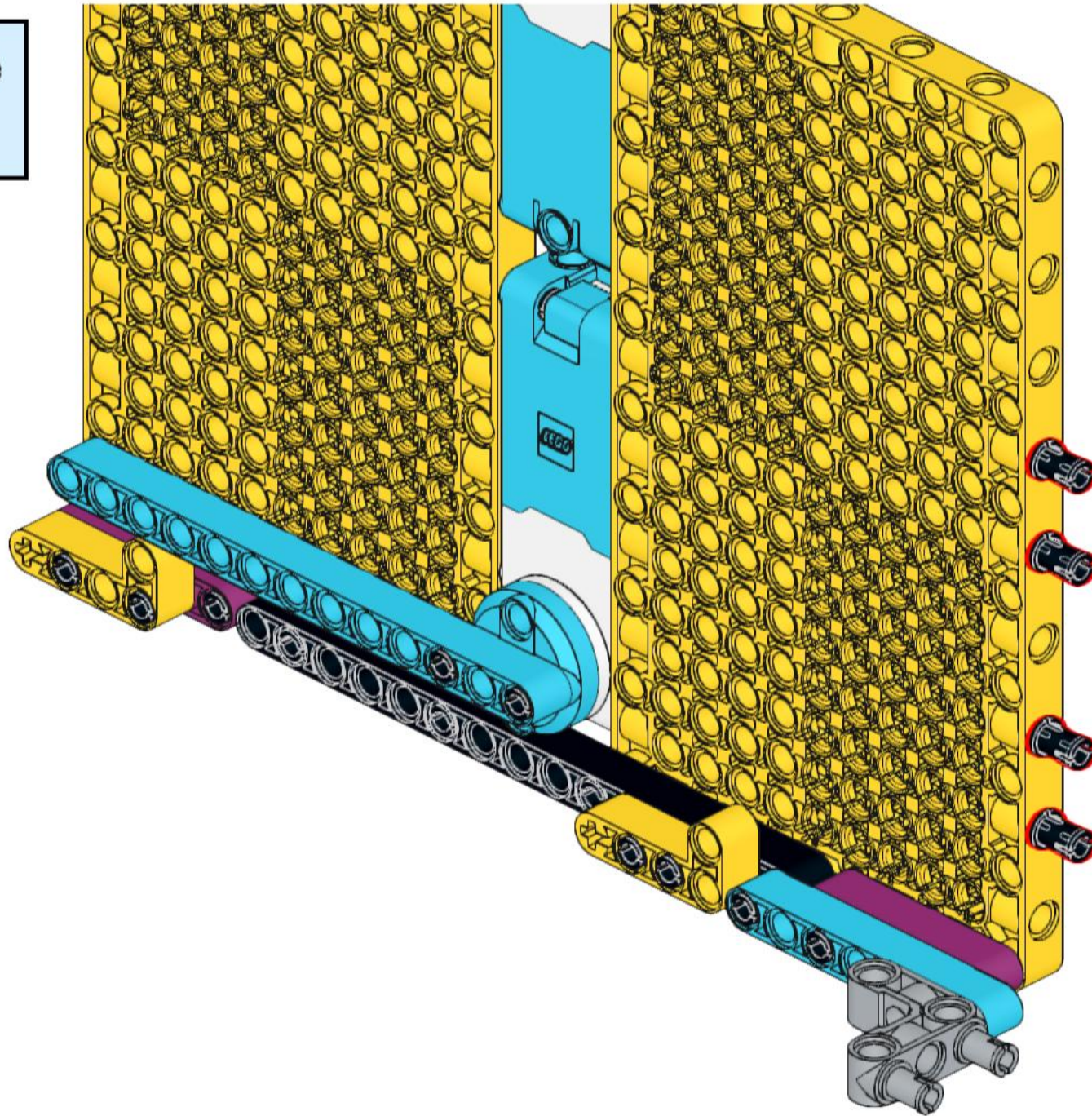

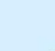

2x

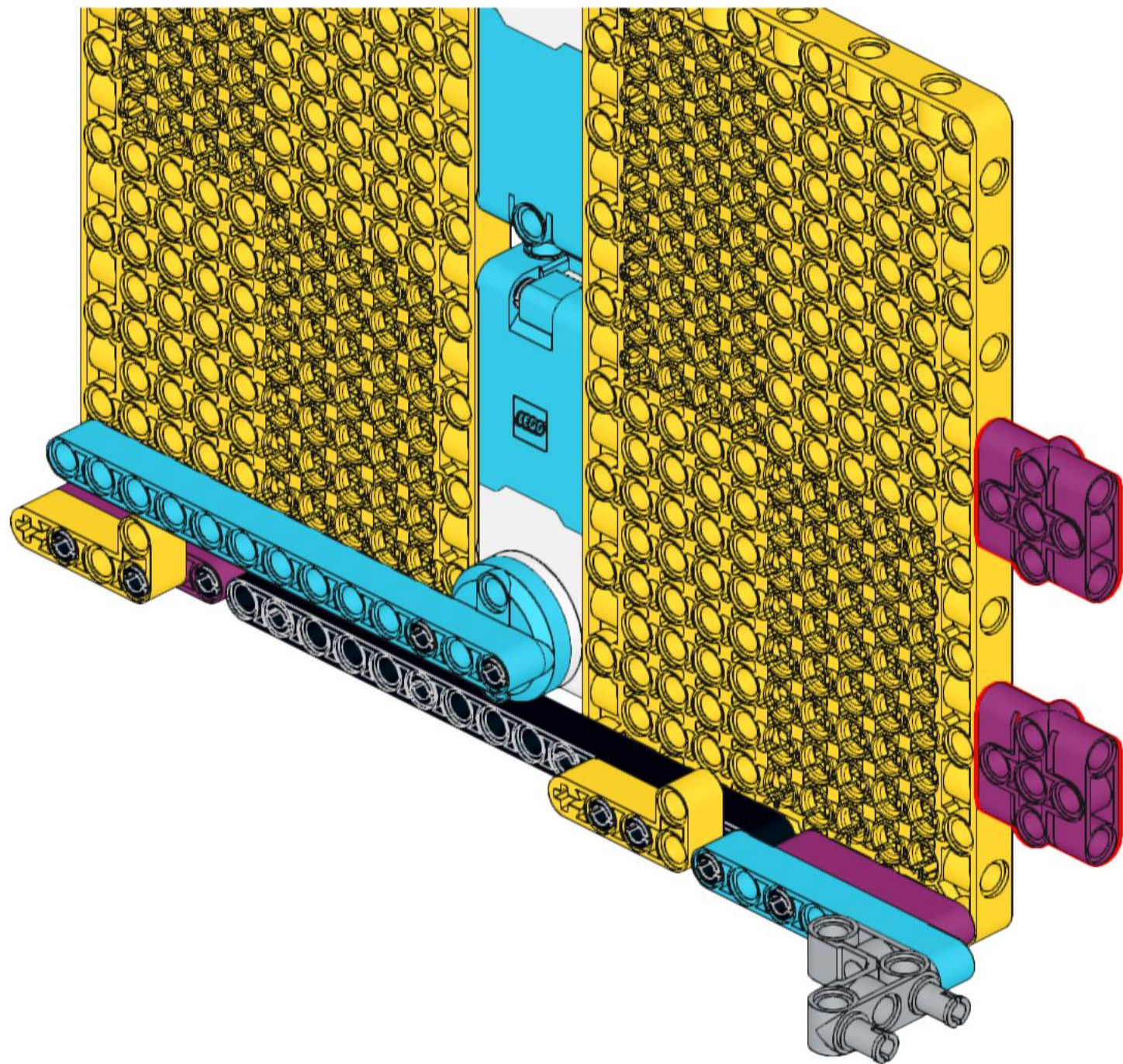

35

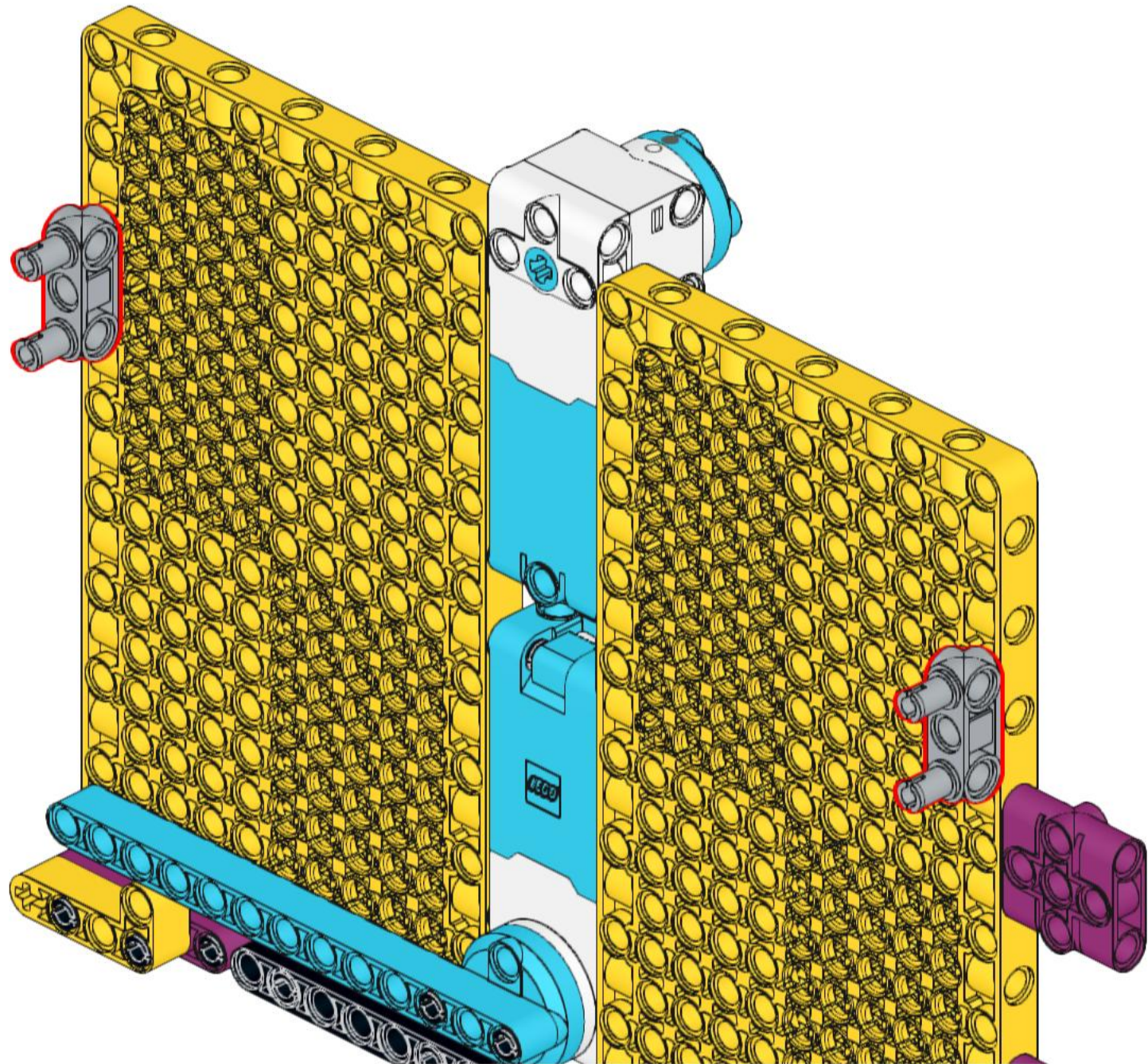
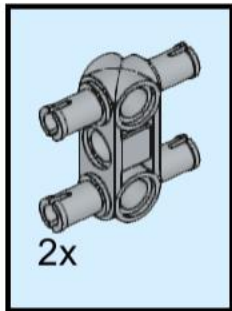

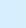

2x

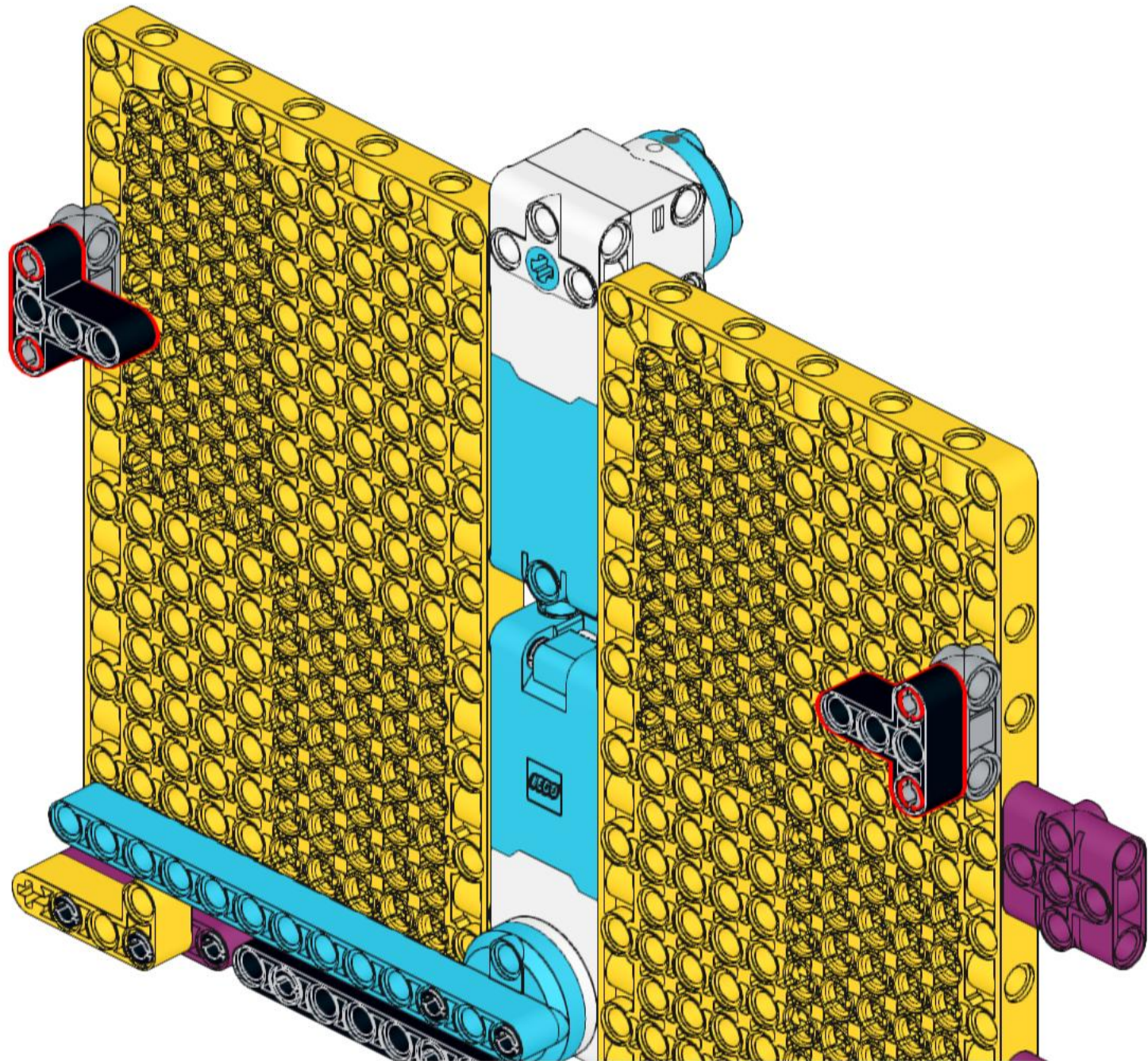

37

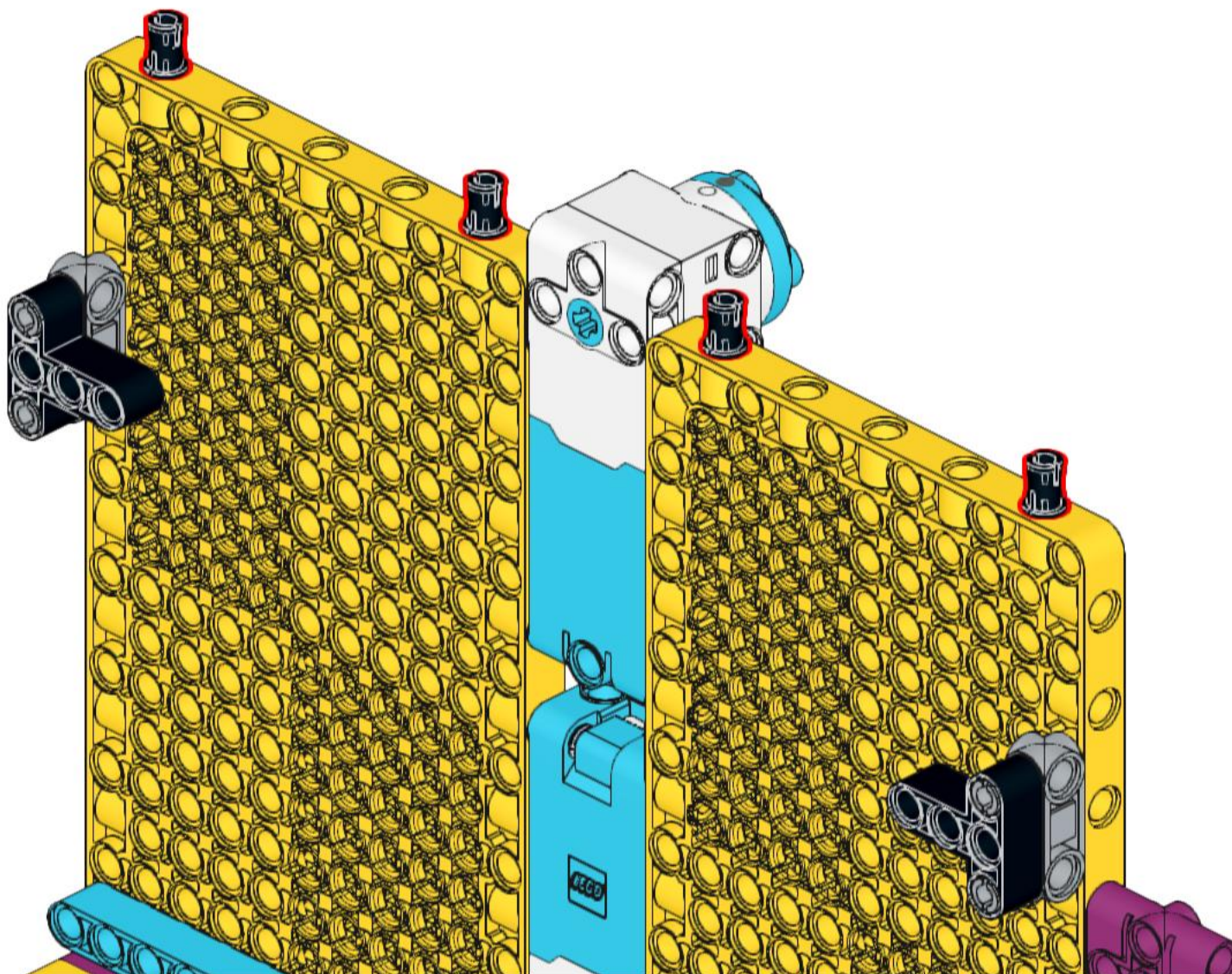

38

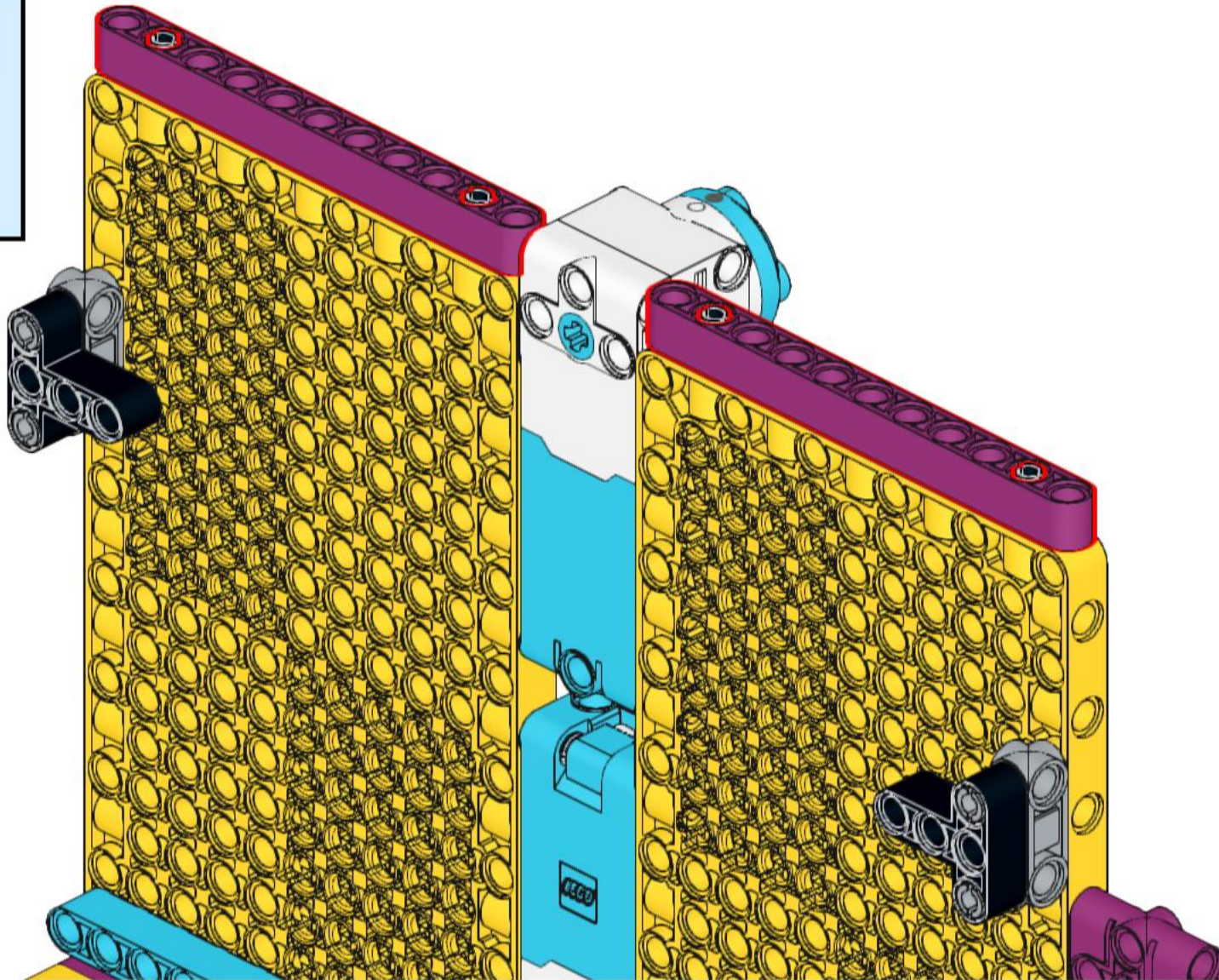
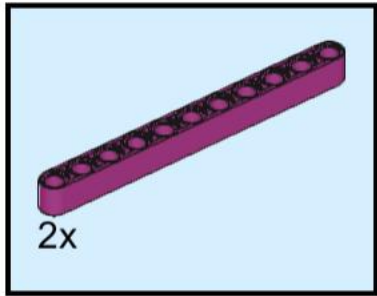
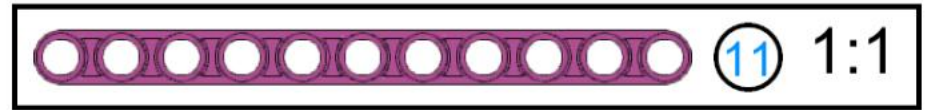

39

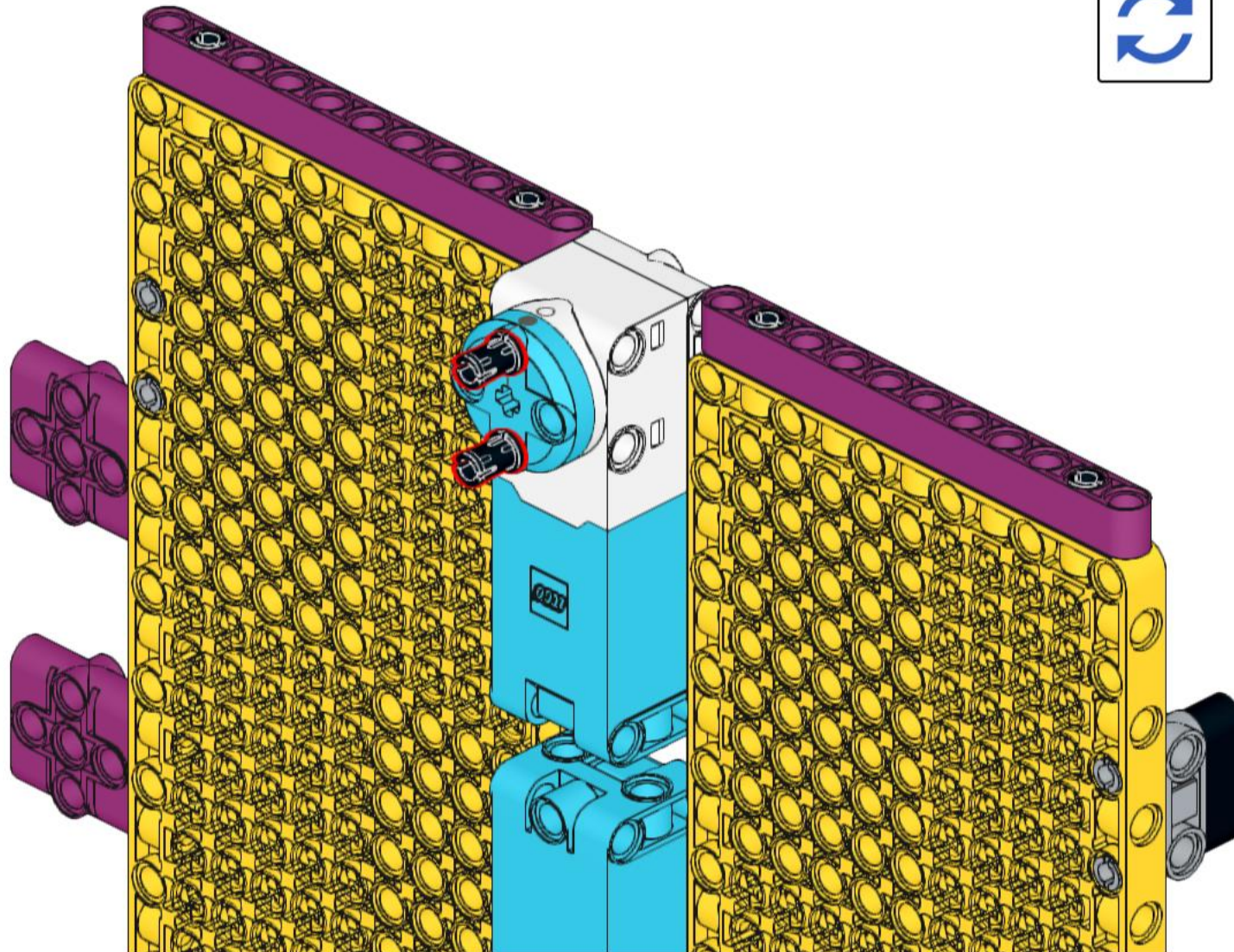

40

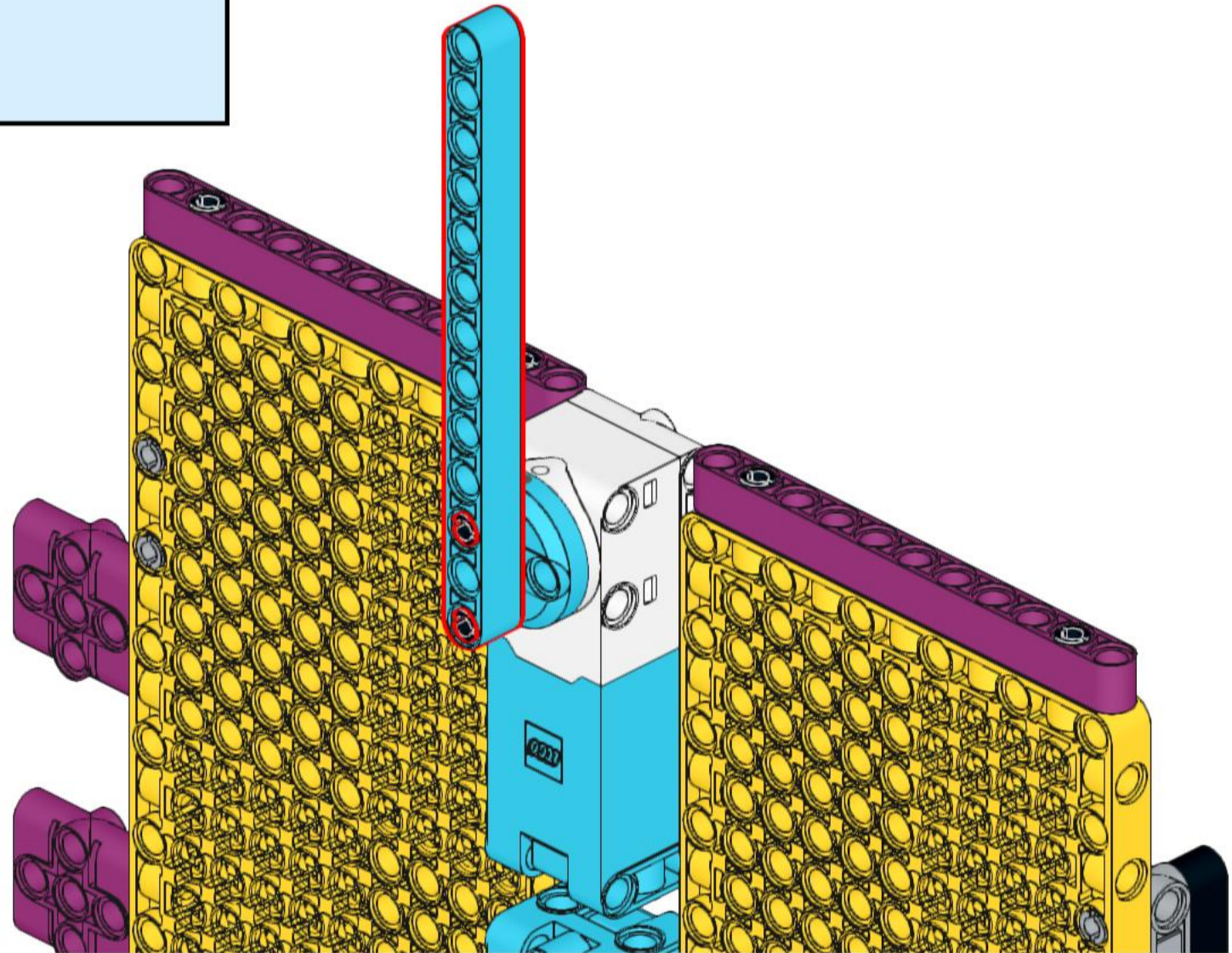
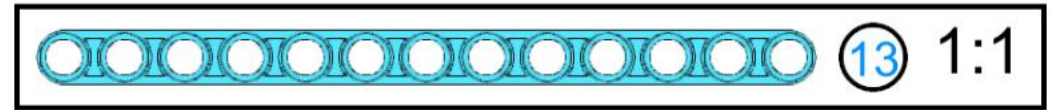
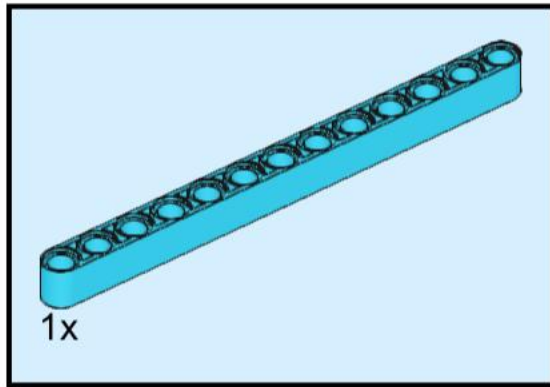

41

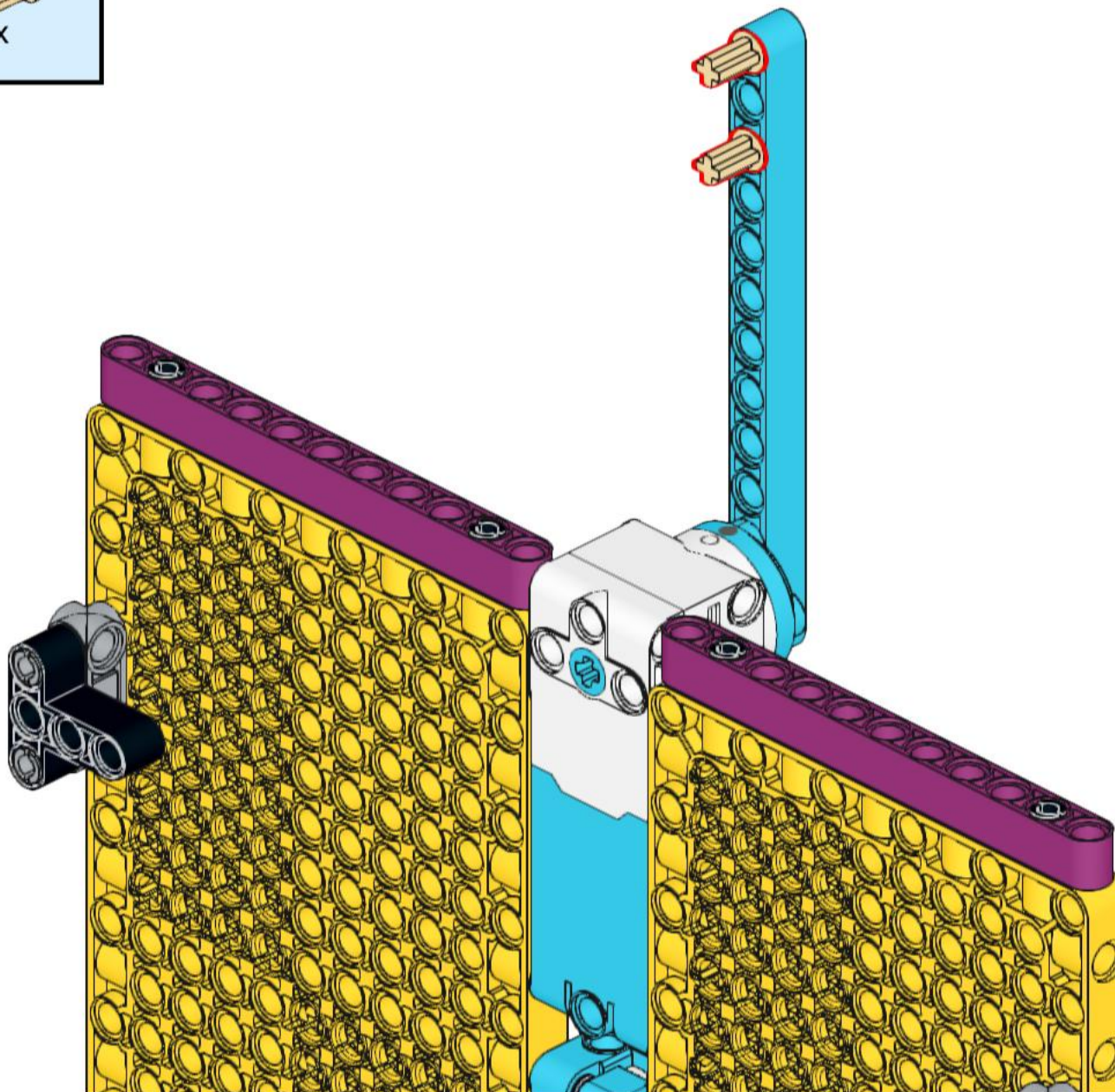
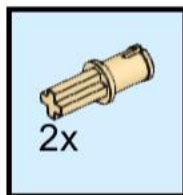

42

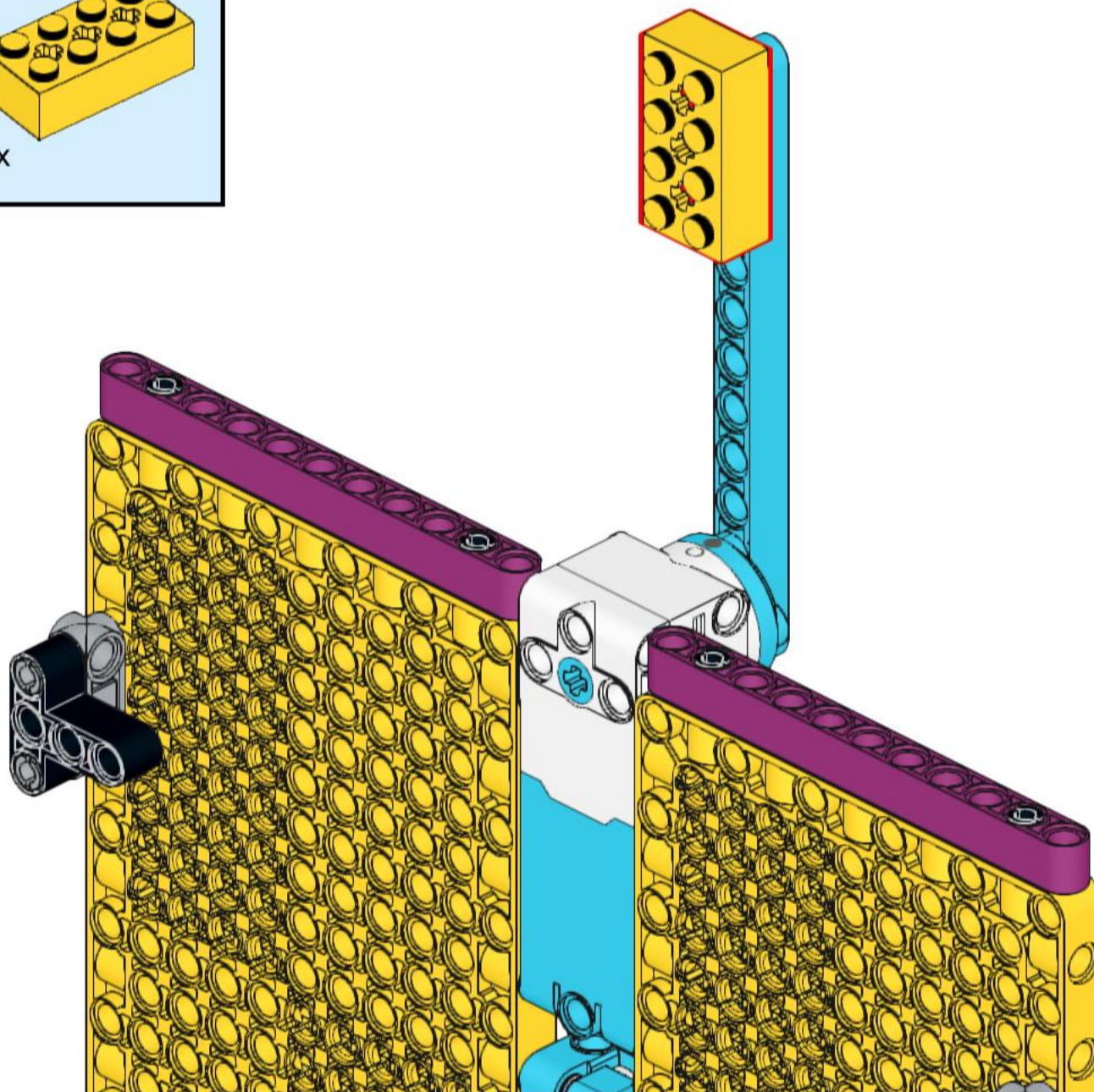
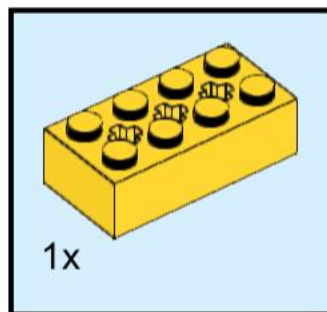

43

Connect the cable from the
bottom medium motor to
port A on the hub.

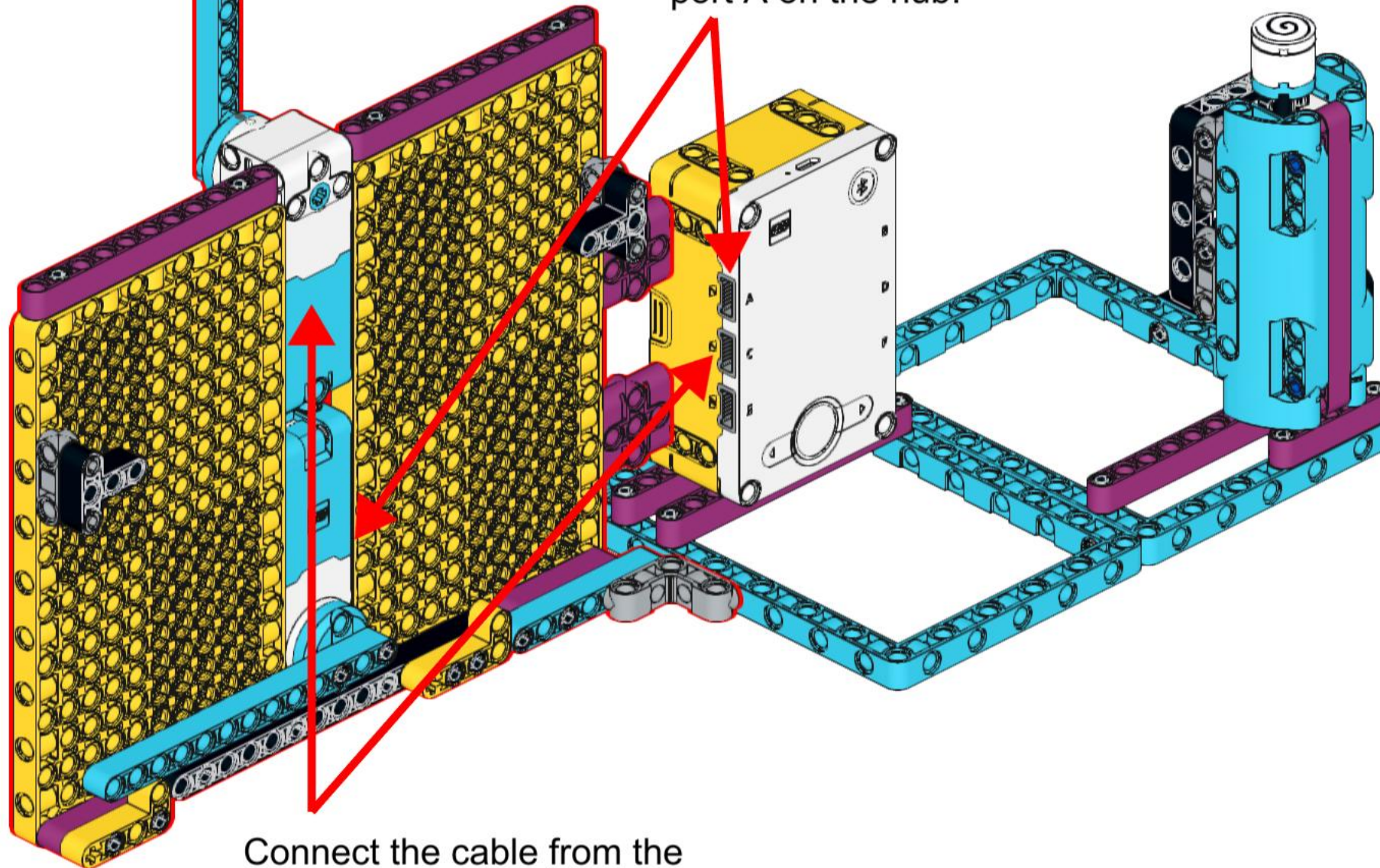

Connect the cable from the
top medium motor to port C
on the hub.

The final step is to print the thumb power and next thumb images. Cut them out using the outline as a guide. Slot the power meter image behind the blue pointer and black tabs. Attach the next thumb image to the yellow brick using some Blu-Tack. See the image below for reference.

